

Fleetguard



上海弗列加

PRODUCT CATALOG 2009



产品目录

空滤器总成 Air cleaner

油水分离器 Fuel water separator

OEM 版

上海弗列加滤清器有限公司
SHANGHAI FLEETGUARD FILTER CO.,LTD.

Forward



编前语

本目录适用于OEM厂商查询空滤产品总成、油水分离器产品，从而了解产品的各项性能、尺寸参数和设备制造名称、设备制造商零件号等信息。

本目录是为了方便客户查询而编制，尽可能做到准确，但不明确或暗示地保证目录的准确程度。这本零件目录所包含的全部技术规格，以及应用范围等数据，均来自权威资料，从供应产品的原生产工厂安装资料中取得。

很多制造厂商允许发动机按照技术规格，选择不同型号滤清器，而制造厂商亦可能在不同生产年份变换生产线，使用者亦相应随之变更，因此，这本零件目录不能明确显示所有型号发动机，对应使用何种技术规格的滤清器。

为确保符合技术规格适合应用范围，最可靠的方法，是根据原生产厂商的产品号，对应查找上海弗列加编号。上海弗列加对滤清器用错机型不负责任。

Forward

This catalog is used to check products like air cleaner, fuel water separators. Thus you can learn the performance characteristic size and OEM names, OEM parts numbers, etc.

The information contained in this catalog is furnished for the convenience for our customers and is as accurate as possible. However, the manufacturer makes no guarantee, either expressed or implied, as to its accuracy.

All other specifications and application information contained in this catalog are taken from authoritative information. Every attempt has been made to supply original factory installation information.

Many manufacturers offer engine and/or filter options on specific models, manufactures may make production line changes on a model during the production year, owners may modify equipment. Therefore, it is impossible to determine that all models utilize the specific filter indicated in this catalog. The most accurate method of insuring the correct filter for a specific application is to cross reference to the manufacturer's filter part number Fleetguard is not responsible for misapplications.

一. 空滤总成客户指引（6-23页）

1. 客户可以根据每页页首标注的产品流量的大小选择自己需要查询的产品。
2. 客户可以根据“订货号”这栏的信息订购需要购买的空滤总成或空滤芯。
3. 客户可以根据“滤芯套装订货号”这栏的信息订购需要购买套装滤芯。
4. “零件号”这栏只作为客户参考信息，不能用来订购相应的产品。
5. 表格中所有“N/A”均表示无此配置。

I. AIR CLEANER'S CUSTOMER GUIDANCE (Page 6-23)

1. CHOOSE PRODUCTS ACCORDING TO THE LABELED FLOW RATE ON THE PAGE HEADING.
2. ORDER THE AIR CLEANER OR AIR FILTER ELEMENT ACCRODING TO "SALES PART NO".
3. ORDER AIR FILTER ELEMENT ACCORDING TO"ELEMENT SET SALES PART NO"
4. "PART NO." IS ONLY CUSTOMER REFERENCE. IT CAN NOT USE TO PLACE AN ORDER.
5. ALL THE "N/A" IN THE LIST MEANS "NOT APPLICABLE"

二. 燃油水分离器客户指引（24-32页）

1. 客户可以根据“额定流量”栏标注的产品流量的大小选择自己需要查询的产品。
2. 客户可以根据自己需要配置的产品在标注（订货号）的栏里 选择订购产品型号。
3. 部分产品的配件可以购买，而有些配件则不能购买，请客户在SFG客服人员指导下购买，客服免费咨询电话800—820—1118。
4. 表格中所有“N/A”均表示无此配置。

II. FUEL WATER SEPERATOR'S CUSTOMER GUIDANCE (Page 24-32)

1. CHOOSE THE PRODUCTS ACCORDING TO THE LABELED FLOW VOLUME IN THE "FLOW RATE".
2. CHOOSE AND ORDER THE PRODCUT UNDER THE LABELED "SALES PART NO."
3. THE FITTINGS OF SOME PRODCUTS CAN BE PURCHASED, SOME ARE NOT AVAILABLE. PLEASE CALL THE CUSTOMER SERVICE AND FEEL FREE TO CALL 800-820-1118.
4. ALL "N/A" IN THE LIST MEANS "NOT APPLICABLE"

缩写说明：Abbreviation Instruction

SFG

上海弗列加滤清器有限公司

Shanghai Fleetguard Filter Co., Ltd.

| | |
|---|----|
| 一. 空滤器总成 (流量) Air Cleaner (Flow rate)..... | 4 |
| 1. 空气预滤器 Air precleaner..... | 8 |
| 2. 240 m ³ /h 流量空滤器 Air Cleaner..... | 9 |
| 3. 270 m ³ /h 流量空滤器 Air Cleaner..... | 10 |
| 4. 420 m ³ /h 流量空滤器 Air Cleaner..... | 11 |
| 5. 650 m ³ /h 流量空滤器 Air Cleaner..... | 12 |
| 6. 900 m ³ /h 流量空滤器 Air Cleaner..... | 13 |
| 7. 1200 m ³ /h 流量空滤器 Air Cleaner..... | 14 |
| 8. 1300 m ³ /h 流量空滤器 Air Cleaner..... | 15 |
| 9. 1440 m ³ /h 流量空滤器 Air Cleaner..... | 16 |
| 10. 1500 m ³ /h 流量空滤器 Air Cleaner..... | 17 |
| 11. 1600 m ³ /h 流量空滤器 Air Cleaner..... | 18 |
| 12. 1700 m ³ /h 流量空滤器 Air Cleaner..... | 19 |
| 13. 1800 m ³ /h 流量空滤器 Air Cleaner..... | 20 |
| 14. 1900 m ³ /h 流量空滤器 Air Cleaner..... | 21 |
| 15. 2100 m ³ /h 流量空滤器 Air Cleaner..... | 22 |
| 16. 空滤总成警报器 Restriction Indicators..... | 23 |
| 二. 燃油水分离器 Fuel water separator..... | 24 |
| 1. 带放水阀油水分离器 F/W Filter with drain valve..... | 24 |
| 2. 带底座预滤器 Pre-Cleaner with head..... | 26 |
| 3. 旋装式油水分离器 Spin-on F/W Filter..... | 30 |

产品前缀说明:

| | | |
|-----|-------------|------------------------------------|
| A | 空滤产品临时号 | Air filter temporary part No. |
| G | 汽油滤产品临时号 | Gasoline filter temporary part No. |
| F | 燃油滤产品临时号 | Fuel filter temporary part No. |
| L | 机油滤产品临时号 | Lube filter temporary part No. |
| AF | 空气滤清器滤芯 | Air filter |
| AH | 空气滤清器总成 | Air cleaner |
| AP | 空气预滤器 | Air pre-clearder |
| LF | 机油滤清器 | Lube filter |
| FF | 燃油滤清器 | Fuel filter |
| FS | 燃油滤清器带油水分离器 | Fuel water separator |
| WF | 水过滤器 | Water filter |
| DCA | 冷却添加剂产品 | Coolant |

确定客户需求：

- ◇ 确立对气流的需求
 - 与客户共同查阅发动机性能参数表或者联系发动机生产商
 - 用以下公式计算所需发动机参数
- ◇ 确立最大允许初阻力
 - 与客户共同查阅发动机性能参数表或者联系发动机生产商
 - 如果没有所需的信息，就凭经验采用150mm H₂O, 1.5KPa或者6" H₂O作为一个指导。

确定空滤等级：

- ◇ 按其使用环境分
 - 轻负荷（单级空滤）
公路或者其他区域使用，内流式/外流式，含尘空气
 - 中负荷（双级空滤）
在公路使用，内流式/外流式，洁净空气
 - 重负荷（有安全滤芯的双级空滤）
公路以外的重污染环境中使用
- 如果有疑义，需定义更高等级

选择合适的空滤：

- 在您指定的流量下，通过流量-阻力曲线查找对应的阻力
- 检查几何尺寸参数确保符合客户需求
- 总体尺寸
- 出/入口尺寸和安装位置

确定所需附件：

- 安装支架
- 遮雨盖
- 阻力指示器
- 橡胶弯管，弓形管以及管钳等

空气流量计算公式

$$\text{米制：空气流量 (m}^3\text{/min)} = \frac{\text{体积流量}^1(\text{升}) \times \text{速度}^2 \times \text{VE}^3 \times \text{PF}^4}{1000 \times \text{CF}}$$

¹发动机排量（升）；²最大发动机RPM；³体积效率；⁴脉冲因子

$$\text{英制：空气流量 (CFM)} = \frac{\text{体积流量}^1(\text{CID}) \times \text{速度}^2 \times \text{VE}^3 \times \text{PF}^4}{1728 \times \text{CF}}$$

¹发动机排量（立方英寸）；²最大发动机RPM；³体积效率；⁴脉冲因子

体积效率（VE）

- VE=对每个新的发动机设计可能大于2
- VE=1.3-1.8，对于有涡轮增压器的4冲程发动机
- VE=0.85，对于自然送气的4冲程发动机
- VE=1.4，对有Roots-Compressor(风机)的发动机
- VE=1.9，对于有涡轮增压器的2冲程发动机

循环因子（CF）

- CF=2,对于四冲程发动机
- CF=1，对于二冲程发动机

脉冲因子（PF）

- 仅用于具有自然送气和少于3缸的发动机
- PF=4，一缸
- PF=2，两缸
- PF=1.33，三缸

怎样选择空滤器总成 How to select an Air Cleaner

Determine the requirements

- ◇ Establish the requirements for air flow
 - Check with customers for engine data sheet or contact engine manufacturer
 - Calculate from the available engine data using the formula below
- ◇ Establish the maximum allowable initial restriction
 - Check with customer for engine data sheet or contact engine manufacturer
 - If no information available use the 150mm H₂O, 1.5KPa or 6" H₂O a rule of thumb value

Determine the class of air cleaner

- ◇ What type of application/ environment will it operate in?
 - **Light duty** (single stage air cleaner)
 - On highway, inside/outside use with clean air
 - **Medium duty** (2 stage air cleaner)
 - On/off highway, inside/outside use with dust in the air
 - **Heavy duty** (2 stage air cleaners with safety element)
 - Off road equipment with heavy dust in the air

...Always over-specify if in doubt

Select an appropriate air cleaner

- Examine the flow vs restriction curves to determine the restriction at your given flow rate
- Check the dimension data to ensure it will fit the customers demand
- Overall size
- Inlet & outlet size installed position

Determine the accessories needed

- Mounting bracket(s)
- Weather Hood
- Restriction Indicator
- Rubber elbows, Hump Hoses and Hose Clamps etc.

Air Flow Calculation formula

$$\text{Metric : Air flow in m}^3/\text{min} = \frac{\text{swept volume}^1(\text{liters}) \times \text{speed}^2 \times \text{VE}^3 \times \text{PF}^4}{1000 \times \text{CF}}$$

¹ engine displacement in liters; ² maximum engine RPM; ³ Volumetric Efficiency; ⁴ Pulsation factor

$$\text{Imperial : Air flow in CFM} = \frac{\text{swept volume}^1(\text{CID}) \times \text{speed}^2 \times \text{VE}^3 \times \text{PF}^4}{1728 \times \text{CF}}$$

¹ engine displacement in cubic inches; ² maximum engine RPM; ³ Volumetric Efficiency; ⁴ Pulsation factor

Volumetric Efficiency (VE)

- VE= can be greater than > 2 for very new engine designs
- VE=1.3-1.8 for 4 stroke engine with turbocharger
- VE=0.85 for 4 stroke engine that is naturally aspirated
- VE=1.4 for 2 stroke (cycle) engine with Roots-compressor (blower)
- VE=1.9 for 2 stroke (cycle) engine with Turbocharger

Cycle Factor (CF)

- CF=2 for a four stroke (cycle) engine
- CF=1 for a 2 stroke (cycle) engine

Pulsation Factor (PF) – only applies to engines that are *both naturally aspirated and having 3 cylinders or less*

- PF=4, if only 1 cylinder
- PF=2, for 2 cylinders
- PF=1.33, for 3 cylinders

如何确定空滤器的设计流量 How to get the design flow rate of Air filter

首先确定发动机的空气需要量：

◇方法一：通过发动机的排量和转速进行计算空气需要量

$$\text{二冲程发动机空气需要量 (V)} = \frac{\text{发动机排量 (L)} \times \text{发动机最高转速 (rpm)} \times \text{充气系数}}{1000}$$

$$\text{四冲程发动机空气需要量 (V)} = \frac{\text{发动机排量 (L)} \times \text{发动机最高转速 (rpm)} \times \text{充气系数}}{2000}$$

- 二冲程发动机的充气系数为 0.7
- 四冲程发动机的充气系数为 0.9
- 增压不中冷发动机的充气系数为 1.7
- 增压水中冷发动机的充气系数为 2
- 增压空对空中冷发动机的充气系数为 2.3

◇方法二：根据发动机的功率进行计算空气需要量

| | | | | | |
|-----|-----|-----|-----|-----|-----|
| 1 | 2 | 1.5 | 1.5 | 3 | 3 |
| 2 | 1.4 | 1.2 | 1.2 | 2 | 1.4 |
| 3 | 1.3 | 1.1 | 1.1 | 1.4 | 1.2 |
| 4 | 1.1 | 1 | 1 | 1.2 | 1.1 |
| ≥ 5 | 1 | 1 | 1 | 1 | 1 |

对于5缸及5缸以上自然吸气型发动机以及所有的增压型柴油机，
发动机空气需要量响应就是空滤器的设计流量。

以上公式仅用来作为较粗糙的计算，但对于空滤器的选择还是有一定的参考意义。

常用单位的换算：

- 1 kPa = 4.019 英寸水柱 = 0.2953 英寸汞柱 = 0.145 磅 / 平方英寸
- 1 M³ / h = 0.58858 英尺³ / 分钟
- 1 m / min = 3.2808 英尺 / 分钟
- 1L = 0.001 M³ = 61.024 英寸³
- 1 英寸水柱 = 0.2488 kPa 1 英寸汞柱 = 3.3865 kPa
- 1 psi = 6.895 kPa 1 bar = 100 kPa
- 1 cfm = 1.699 m³ / h = 0.02831685 m³ / min
- 1 ft / min = 0.3408 m / min
- 1 马力 = 735.5 w
- 1 cfm / ft² = 5.081 L / m³.s

如何确定空滤器的设计流量 How to get the design flow rate of Air filter

First define the air flow volume great demand for engine:

◇ Approach 1: according to displacement and engine speed

$$\text{Air flow of 2 stroke cycle (V)} = \frac{\text{displacement (L)} \times \text{maximum engine speed (rpm)} \times \text{gassing factors}}{1000}$$

$$\text{Air flow of 4 stroke cycle (V)} = \frac{\text{displacement (L)} \times \text{maximum engine speed (rpm)} \times \text{gassing factors}}{2000}$$

- Gassing factors of 2 stroke cycle engine are 0.7
- Gassing factors of 4 stroke cycle engine are 0.9
- Gassing factors of engine without water-inter-cooling are 1.7
- Gassing factors of engine with water-inter-cooling are 2
- Gassing factors of engine with air-inter-cooling are 2.3

◇ Approach 2: according to engine power

| | | | | | |
|-----|-----|-----|-----|-----|-----|
| 1 | 2 | 1.5 | 1.5 | 3 | 3 |
| 2 | 1.4 | 1.2 | 1.2 | 2 | 1.4 |
| 3 | 1.3 | 1.1 | 1.1 | 1.4 | 1.2 |
| 4 | 1.1 | 1 | 1 | 1.2 | 1.1 |
| ≥ 5 | 1 | 1 | 1 | 1 | 1 |

For naturally aspirated engine and diesel with 5 or more cylinders, the great demand air flow is equal to designed flow rate.

The above formula could only be an approximate estimate while would be a reference for AF selection.

The common exchange calculation of unit :

- 1 kPa = 4.019 inchH₂O = 0.2953 inchHg = 0.145 pound / sqft
- 1 M³ / h = 0.58858 feet³ / min
- 1 m / min = 3.2808 feet / min
- 1L = 0.001 M³ = 61.024 inch³
- 1 inchH₂O = 0.2488 kPa 1 inchHg = 3.3865 kPa
- 1 psi = 6.895 kPa 1 bar = 100 kPa
- 1 cfm = 1.699 m³ / h = 0.02831685 m³ / min
- 1 ft / min = 0.3408 m / min
- 1 马力 = 735.5 w
- 1 cfm / ft² = 5.081 L / m³.s

碗式空气预滤器 Precleaners - Visibowl

橡胶接头 Reducing Adaptors

| 入口直径 (mm) Intake diameter | 零件号 Part No. |
|------------------------------|-------------------|
| 50.8 | AP2000 + 3920175S |
| 50.8 | AP2000 + 3920138S |
| 63.5 | AP3000 + 3930250S |
| 77.22 | AP3000 |
| 101.6 | AP4500 + 3945400S |
| 114.3 | AP4500 |
| 127 | AP5000 |

| 零件号 Part No. | 适用总成 Lids to Suit | 外径 (mm) Outer Dia. | 内径 (mm) Inner Dia. |
|-----------------|----------------------|-----------------------|-----------------------|
| 3920175S | AP2000 | 50.8 | 44.45 |
| 3920138S | AP2000 | 50.8 | 35.05 |
| 3930250S | AP3000 | 76.2 | 63.5 |
| 3930225S | AP3000 | 76.2 | 57.15 |
| 3930200S | AP3000 | 76.2 | 50.8 |
| 3945400S | AP4500 | 114.3 | 101.6 |
| 3945375S | AP4500 | 114.3 | 92.5 |
| 3945300S | AP4500 | 114.3 | 76.2 |
| 3950450S | AP5000 | 127 | 114.3 |
| 3950400S | AP5000 | 127 | 104.6 |

盖子 Lids

| 零件号 Part No. | 适用总成 Lids to Suit |
|--------------|-------------------|
| 3960200S | AP2000 |
| 3960300S | AP3000 |
| 3960450S | AP4500 |
| 3960500S | AP5000 |

积灰碗 Bowls

| 零件号 Part No. | 适用总成 Lids to Suit |
|--------------|-------------------|
| 3960200S | AP2000 |
| 3960300S | AP3000 |
| 3960450S | AP4500 |
| 3960500S | AP5000 |

尺寸和流量 Dimension and Air Flow Ratings:

| 零件号 Part No. | A (mm) | B (mm) | C (mm) | D (mm) | E (mm) | 流量 Flow rate (m ³ /min) |
|--------------|--------|--------|--------|--------|--------|------------------------------------|
| AP2000 | 50.8 | 142 | 122 | 46 | 140 | 0.8~2.6 |
| AP3000 | 76.2 | 188 | 158 | 46 | 185 | 2.2~4.8 |
| AP4500 | 114.3 | 272 | 196 | 48 | 267 | 4.2~9.6 |
| AP5000 | 127 | 307 | 196 | 51 | 305 | 9.3~21 |

产品尺寸图 Dimension:

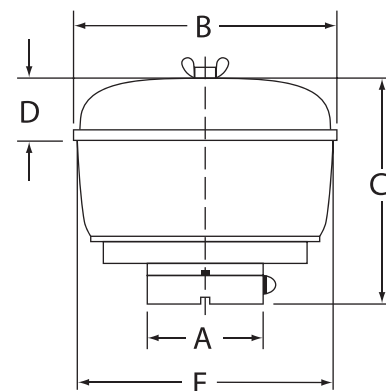

240 m³/h 流量空滤器(塑料) Air Cleaner (Plastic)

产品型号(订货号) Whole Assembly Sales Part No. : A716

| 备件名称 Service Parts Name | 零件号 Part No. | 数量 Qty. | 订货号 Sales Part No. | 滤芯套装订货号 Element SET Sales Part No. | 备注 Notes. |
|-----------------------------|-----------------|------------|-----------------------|---------------------------------------|--------------|
| 主滤芯 Primary Element | A716-020 | 1 | A716-020-AM | A716-SET2 | |
| 安全滤芯 Safety Element | A716-030 | 1 | A716-030-AM | | |
| 排灰阀 Dust Ejection Valve | A753-012 | 1 | | | |
| 防雨帽 Weather Hood | N/A | | | | |
| 抱箍支架 Mounting Bracket | N/A | | | | |
| 阻力指示器 Restriction Indicator | 1W613M | 1 | 1W613M-AM | | 选配 Option |
| 堵塞传感器 Jamming Sensor | KLSK01-10 | 1 | KLSK01-10-AM | | 选配 Option |
| 空滤器盖 Cover Assembly | A753-041 | 1 | | | |
| 旋流片 Fin | N/A | | | | |

产品尺寸图 Dimension:

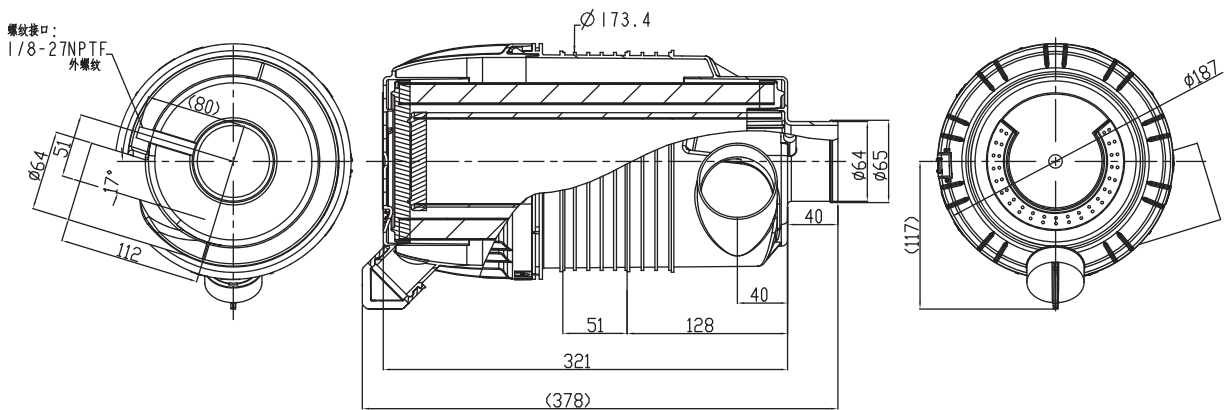

流量阻力曲线图 Restriction-Flow Rate Curve:

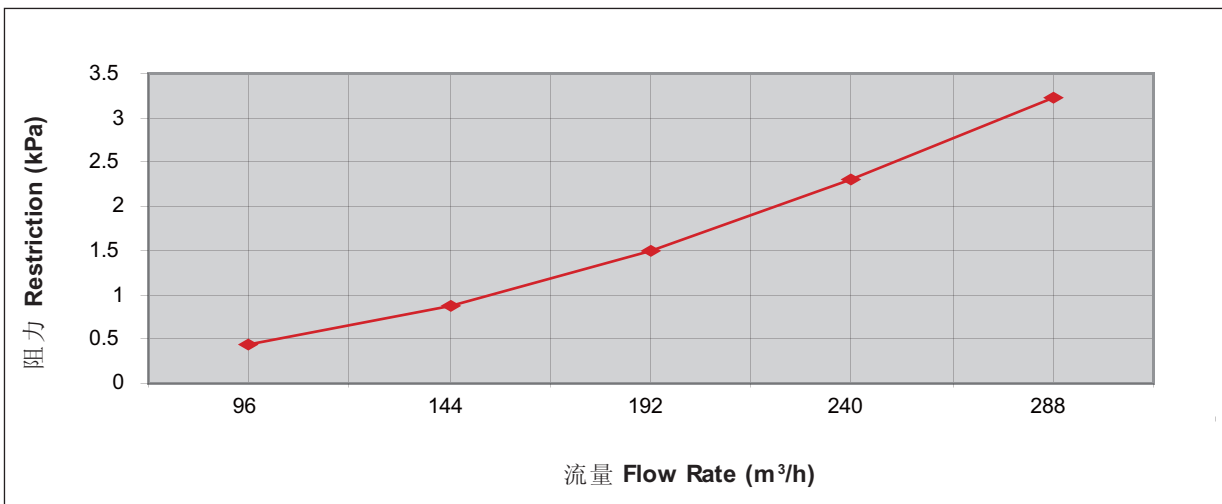

270 m³/h 流量空滤器(塑料) Air Cleaner (Plastic)

产品型号(订货号) Whole Assembly Sales Part No.: A753

| 备件名称 Service Parts Name | 零件号 Part No. | 数量 Qty. | 订货号 Sales Part No. | 滤芯套装订货号 Element SET Sales Part No. | 备注 Notes. |
|-----------------------------|-----------------|------------|-----------------------|---------------------------------------|--------------|
| 主滤芯 Primary Element | A753-020 | 1 | A753-020-AM | A753-SET2 | |
| 安全滤芯 Safety Element | A753-030 | 1 | A753-030-AM | | |
| 排灰阀 Dust Ejection Valve | A753-012 | 1 | | | |
| 防雨帽 Weather Hood | N/A | | | | |
| 抱箍支架 Mounting Bracket | A753-057 | 1 | A753-057-AM | | 选配 Option |
| 阻力指示器 Restriction Indicator | 1W613M | 1 | 1W613M-AM | | 选配 Option |
| 堵塞传感器 Jamming Sensor | KLSK01-10 | 1 | KLSK01-10-AM | | 选配 Option |
| 空滤器盖 Cover Assembly | A753-041 | 1 | | | |
| 旋流片 Fin | N/A | | | | |

产品尺寸图 Dimension:

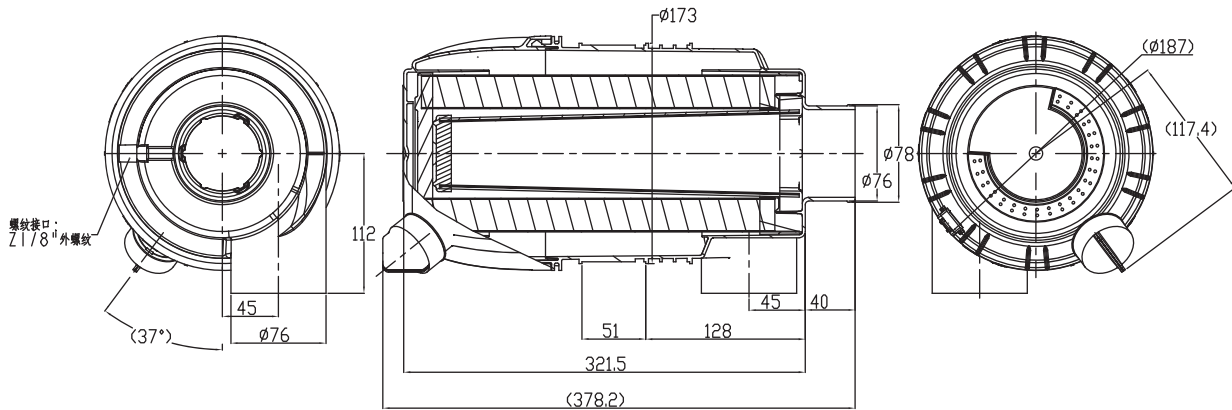

流量阻力曲线图 Restriction-Flow Rate Curve:

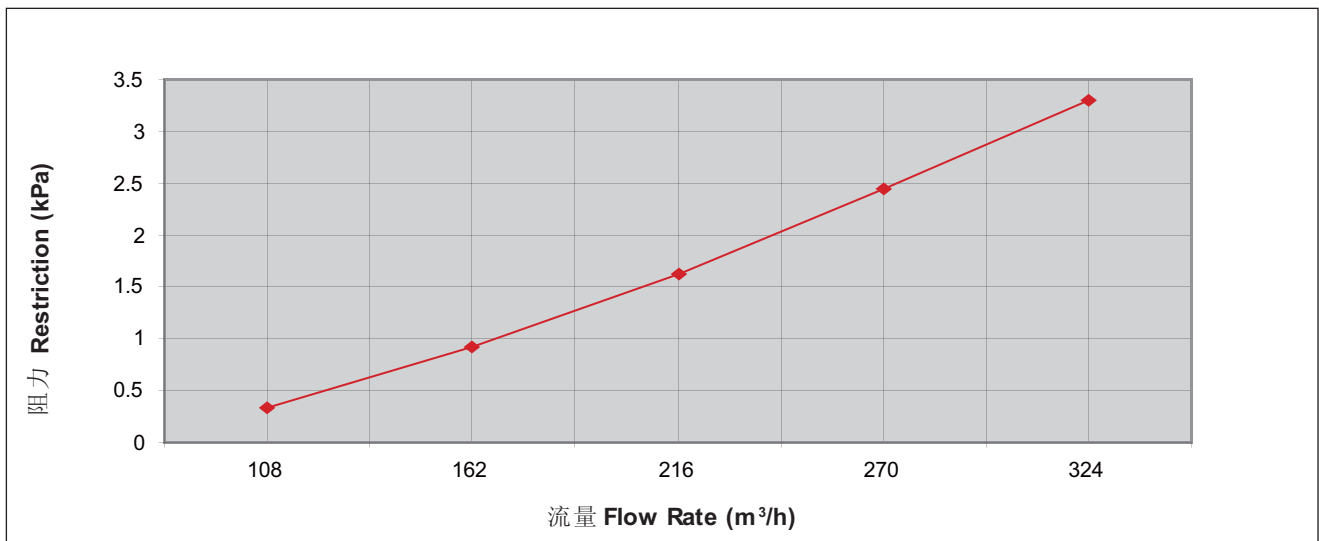

420 m³/h 流量空滤器 Air Cleaner

产品型号(订货号) Whole Assembly Sales Part No.: AH19370-B

| 备件名称 Service Parts Name | 零件号 Part No. | 数量 Qty. | 订货号 Sales Part No. | 滤芯套装订货号 Element SET Sales Part No. | 备注 Notes. |
|-----------------------------|-----------------|------------|-----------------------|---------------------------------------|--------------|
| 主滤芯 Primary Element | 1109QF16-020 | 1 | AF26505 | 1109QF16-SET2 | |
| 安全滤芯 Safety Element | 1109QF16-030 | 1 | AF26506 | | |
| 排灰阀 Dust Ejection Valve | 389164000 | 1 | | | |
| 防雨帽 Weather Hood | 389165200 | 1 | 389165200-AM | | 选配 Option |
| 抱箍支架 Mounting Bracket | N/A | | | | |
| 阻力指示器 Restriction Indicator | N/A | | | | |
| 堵塞传感器 Jamming Sensor | KLSK01-10 | 1 | KLSK01-10-AM | | |
| 空滤器盖 Cover Assembly | 389163900 | 1 | | | |
| 旋流片 Fin | 389163700 | 1 | | | |

产品尺寸图 Dimension:

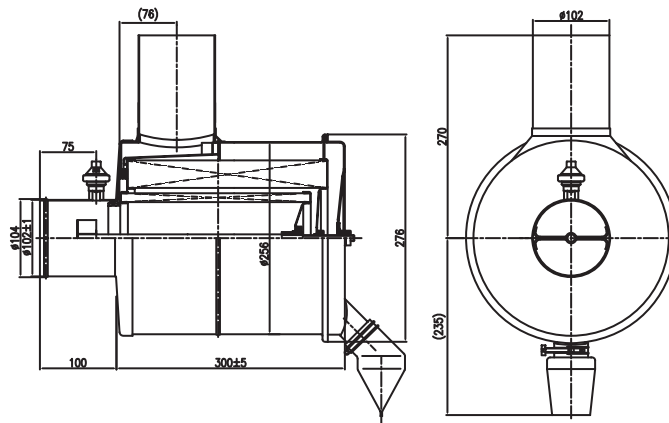

流量阻力曲线图 Restriction-Flow Rate Curve:

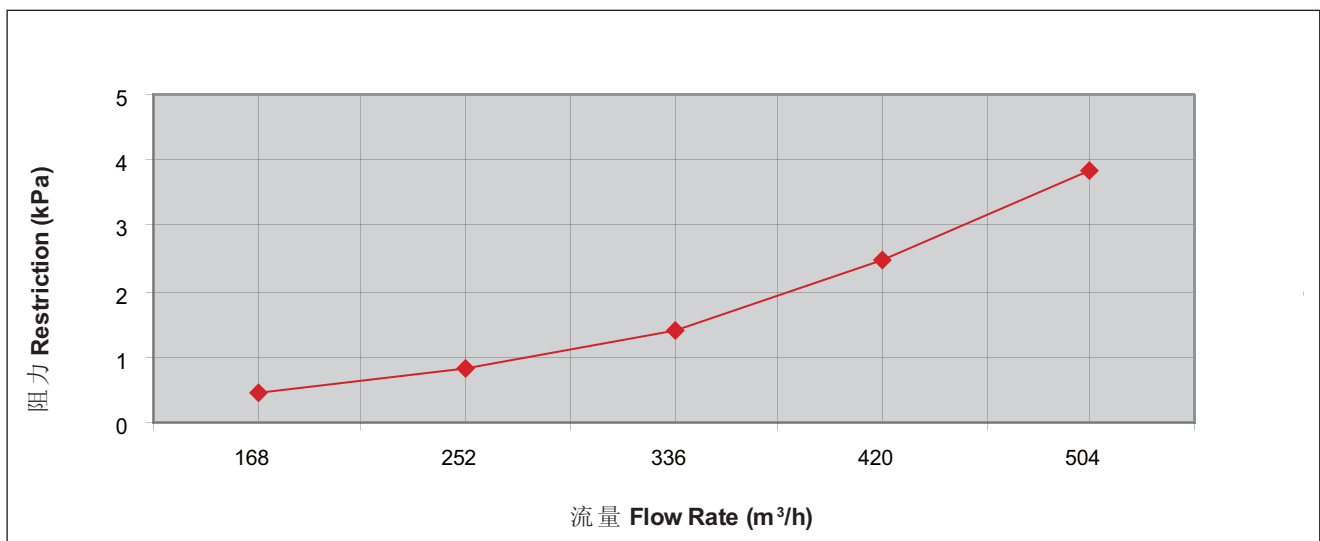

650 m³/h 流量空滤器 Air Cleaner

产品型号(订货号) Whole Assembly Sales Part No. : A900

| 备件名称 Service Parts Name | 零件号 Part No. | 数量 Qty. | 订货号 Sales Part No. | 滤芯套装订货号 Element SET Sales Part No. | 备注 Notes. |
|-----------------------------|-----------------|------------|-----------------------|---------------------------------------|--------------|
| 主滤芯 Primary Element | 389066900 | 1 | AF25268 | 11096B-SET2-AM OR AA2955 | |
| 安全滤芯 Safety Element | 389067600 | 1 | AF25269 | | |
| 排灰阀 Dust Ejection Valve | 389164000 | 1 | | | |
| 防雨帽 Weather Hood | 389165200 | 1 | 389165200-AM | | 选配 Option |
| 抱箍支架 Mounting Bracket | N/A | | | | |
| 阻力指示器 Restriction Indicator | N/A | | | | |
| 堵塞传感器 Jamming Sensor | KLSK01-10 | 1 | KLSK01-10-AM | | |
| 空滤器盖 Cover Assembly | 389163900 | 1 | | | |
| 旋流片 Fin | 389163700 | 1 | | | |

产品尺寸图 Dimension:

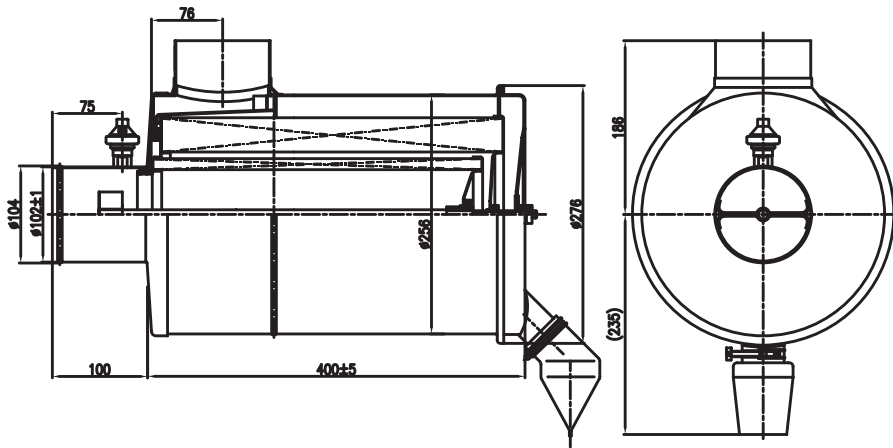

流量阻力曲线图 Restriction-Flow Rate Curve:

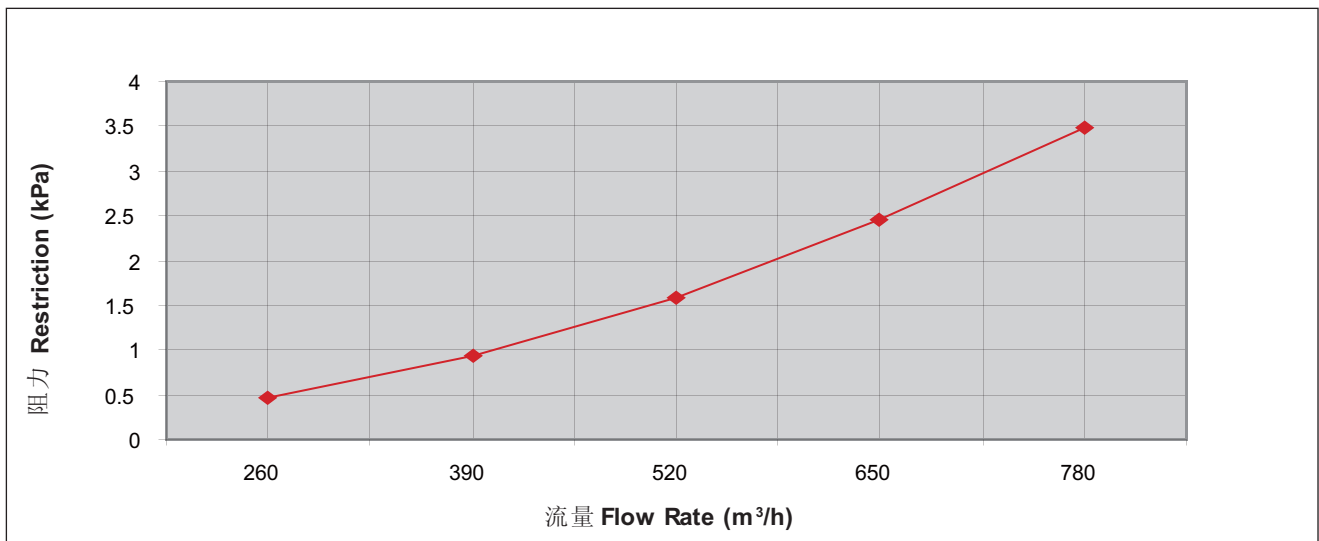

900 m³/h 流量空滤器 Air Cleaner

产品型号(订货号) Whole Assembly Sales Part No. : A453

| 备件名称 Service Parts Name | 零件号 Part No. | 数量 Qty. | 订货号 Sales Part No. | 滤芯套装订货号 Element SET Sales Part No. | 备注 Notes. |
|-----------------------------|-----------------|------------|-----------------------|---------------------------------------|--------------|
| 主滤芯 Primary Element | 389042800 | 1 | AF25270 | 1109N-SET2-AM OR AA2956 | |
| 安全滤芯 Safety Element | 389045300 | 1 | AF25271 | | |
| 排灰阀 Dust Ejection Valve | 1109E-048 | 1 | | | |
| 防雨帽 Weather Hood | 1109B34-080 | 1 | 1109B34A-FYM | | 选配 Option |
| 抱箍支架 Mounting Bracket | N/A | | | | |
| 阻力指示器 Restriction Indicator | N/A | | | | |
| 堵塞传感器 Jamming Sensor | KLSK01-10 | 1 | KLSK01-10-AM | | |
| 空滤器盖 Cover Assembly | 389509400 | 1 | 389509400-AM | | |
| 旋流片 Fin | 389509300 | 1 | | | |

产品尺寸图 Dimension:

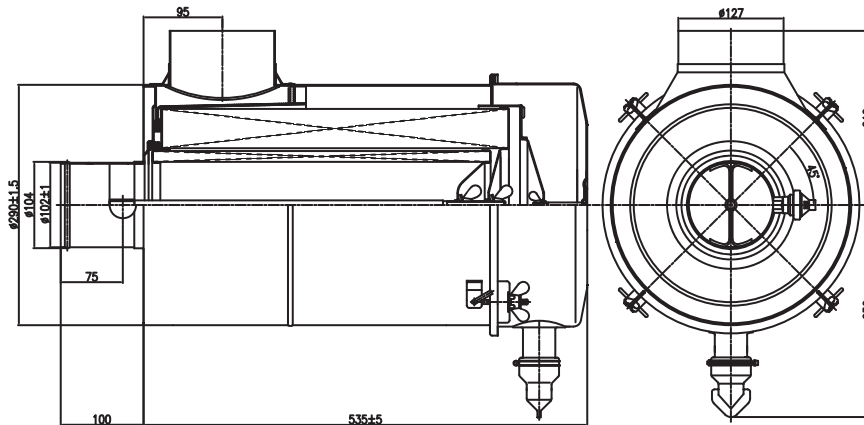

流量阻力曲线图 Restriction-Flow Rate Curve:

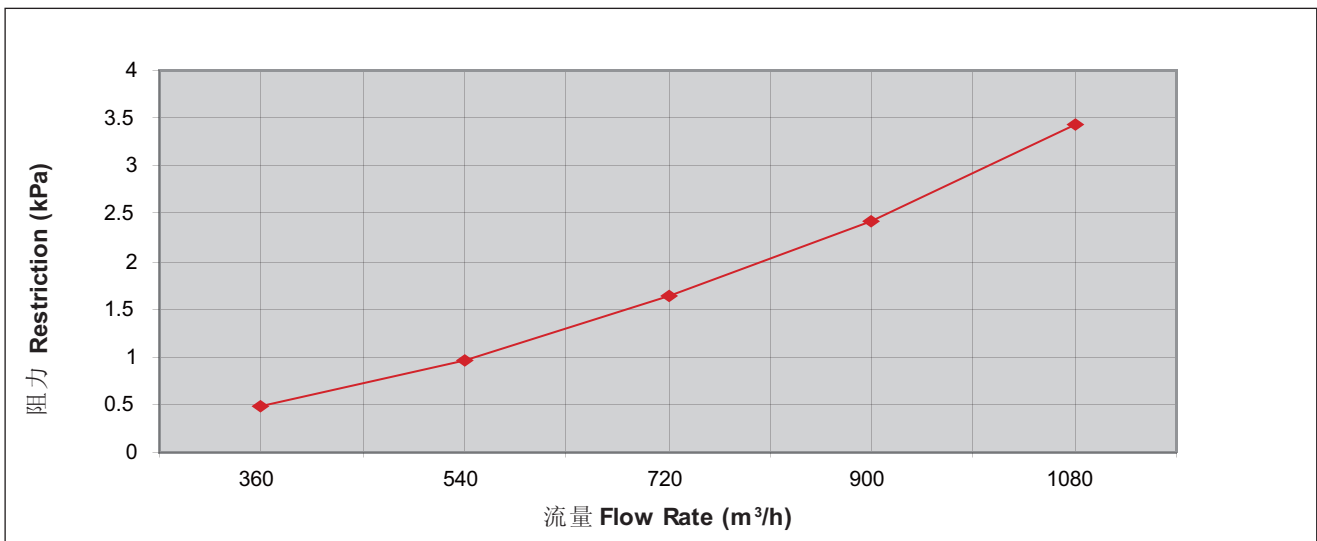

1200 m³/h 流量空滤器 Air Cleaner

产品型号(订货号) Whole Assembly Sales Part No. : A751

| 备件名称 Service Parts Name | 零件号 Part No. | 数量 Qty. | 订货号 Sales Part No. | 滤芯套装订货号 Element SET Sales Part No. | 备注 Notes. |
|-----------------------------|-----------------|------------|-----------------------|---------------------------------------|--------------|
| 主滤芯 Primary Element | A751-020 | 1 | A751-020-AM | A751-SET2 | |
| 安全滤芯 Safety Element | A751-030 | 1 | A751-030-AM | | |
| 排灰阀 Dust Ejection Valve | A753-012 | 1 | | | |
| 防雨帽 Weather Hood | 1109B34-080 | 1 | 1109B34A-FYM | | 选配 Option |
| 抱箍支架 Mounting Bracket | N/A | | | | |
| 阻力指示器 Restriction Indicator | N/A | | | | |
| 堵塞传感器 Jamming Sensor | KLSK01-10 | 1 | KLSK01-10-AM | | |
| 空滤器盖 Cover Assembly | A751-040 | 1 | | | |
| 旋流片 Fin | A751-015 | 1 | | | |

产品尺寸图 Dimension:

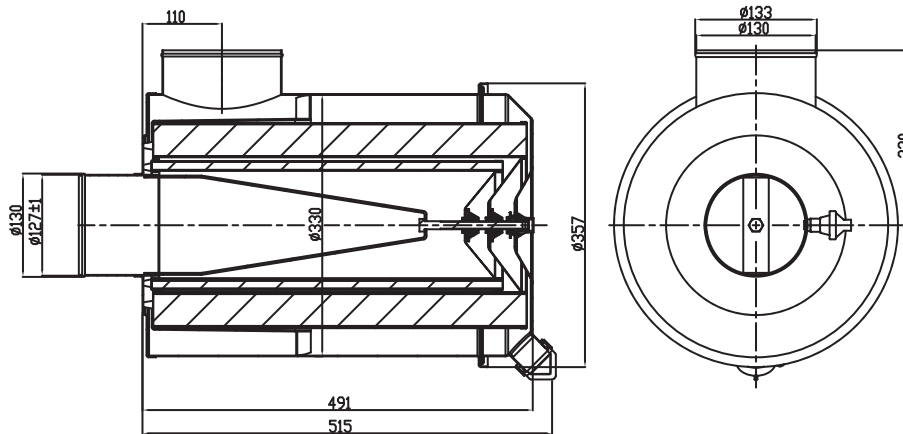

流量阻力曲线图 Restriction-Flow Rate Curve:

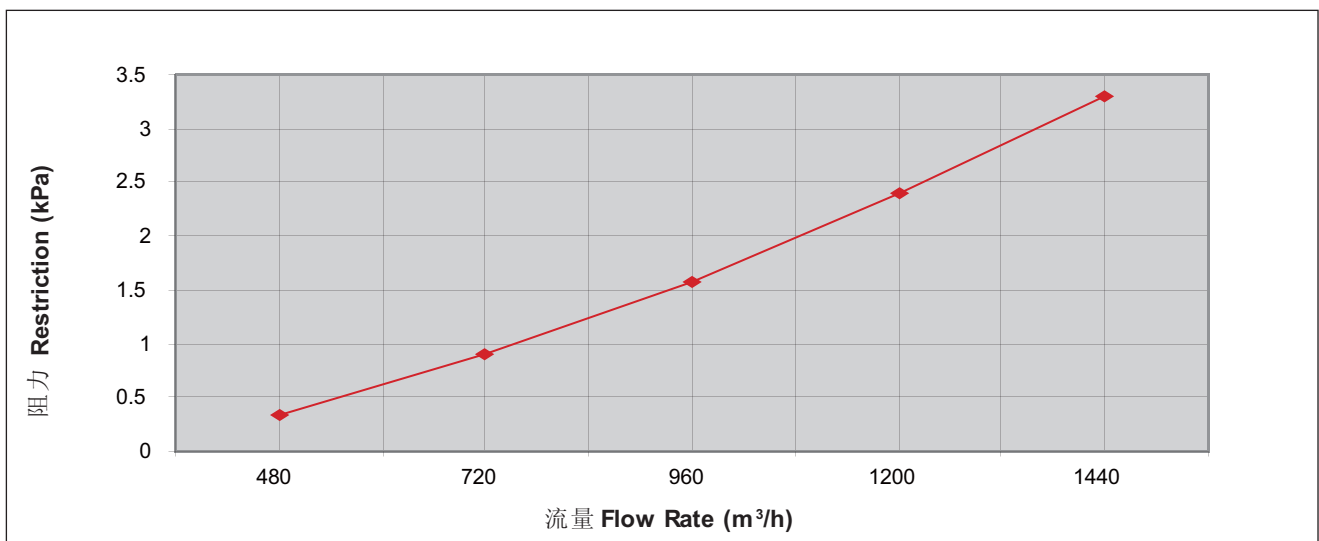

1300 m³/h 流量空滤器 Air Cleaner

产品型号(订货号) Whole Assembly Sales Part No. : AH19351-SL

| 备件名称 Service Parts Name | 零件号 Part No. | 数量 Qty. | 订货号 Sales Part No. | 滤芯套装订货号 Element SET Sales Part No. | 备注 Notes. |
|-----------------------------|-----------------|------------|-----------------------|---------------------------------------|--------------|
| 主滤芯 Primary Element | 389515300 | 1 | AF25276 | 1109N12-SET2-AM OR AA2948 | |
| 安全滤芯 Safety Element | 389515600 | 1 | AF25277 | | |
| 排灰阀 Dust Ejection Valve | 389164000 | 1 | | | |
| 防雨帽 Weather Hood | 3918206S | 1 | 3918206S-FYM | | 选配 Option |
| 抱箍支架 Mounting Bracket | N/A | | | | |
| 阻力指示器 Restriction Indicator | 1W613M | 1 | 1W613M-AM | | |
| 堵塞传感器 Jamming Sensor | N/A | | | | |
| 空滤器盖 Cover Assembly | 389511900 | 1 | 389512100-DBZ | | |
| 旋流片 Fin | 389510500 | 1 | | | |

产品尺寸图 Dimension:

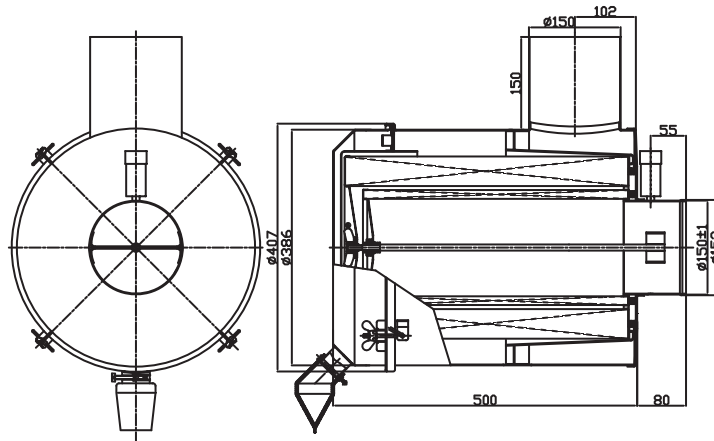

流量阻力曲线图 Restriction-Flow Rate Curve:

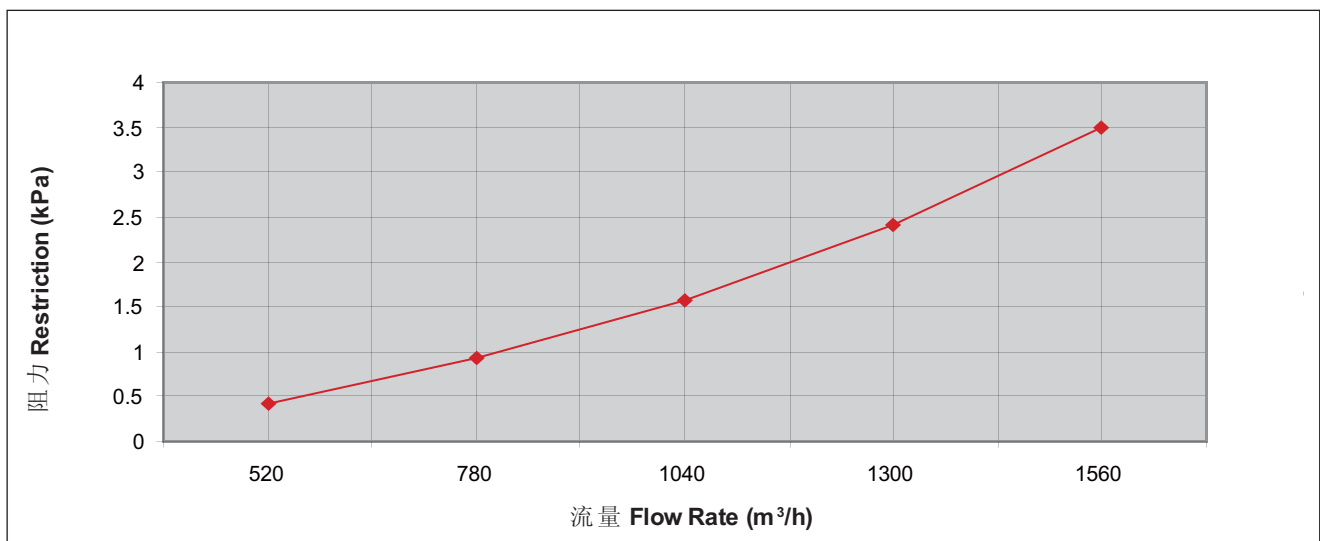

1400 m³/h 流量空滤器 Air Cleaner

产品型号(订货号) Whole Assembly Sales Part No. : A348

| 备件名称 Service Parts Name | 零件号 Part No. | 数量 Qty. | 订货号 Sales Part No. | 滤芯套装订货号 Element SET Sales Part No. | 备注 Notes. |
|-----------------------------|-----------------|------------|-----------------------|---------------------------------------|--------------|
| 主滤芯 Primary Element | 384716500 | 1 | AF928M-A | AF928M-SET2 OR AA2950 | |
| 安全滤芯 Safety Element | A081-030 | 1 | AF26380M | | |
| 排灰阀 Dust Ejection Valve | A006-012 | 1 | | | |
| 防雨帽 Weather Hood | A010-080-B | 1 | 4913719-29 | | 选配 Option |
| 抱箍支架 Mounting Bracket | N/A | | | | |
| 阻力指示器 Restriction Indicator | 1W613M | 1 | 1W613M-AM | | |
| 堵塞传感器 Jamming Sensor | N/A | | | | |
| 空滤器盖 Cover Assembly | AH19112-BC-046 | 1 | | | |
| 旋流片 Fin | N/A | | | | |

产品尺寸图 Dimension:

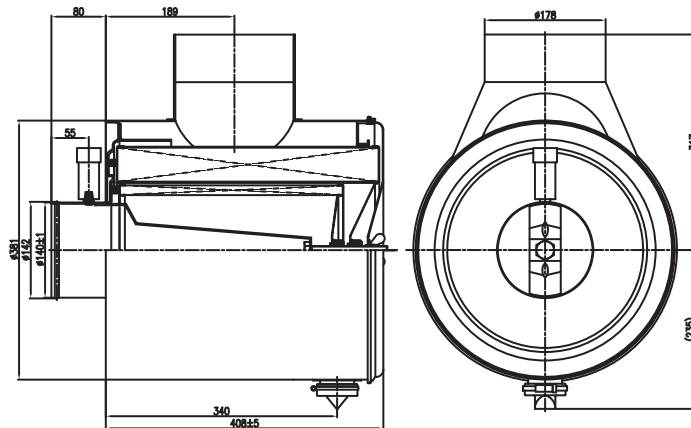

流量阻力曲线图 Restriction-Flow Rate Curve:

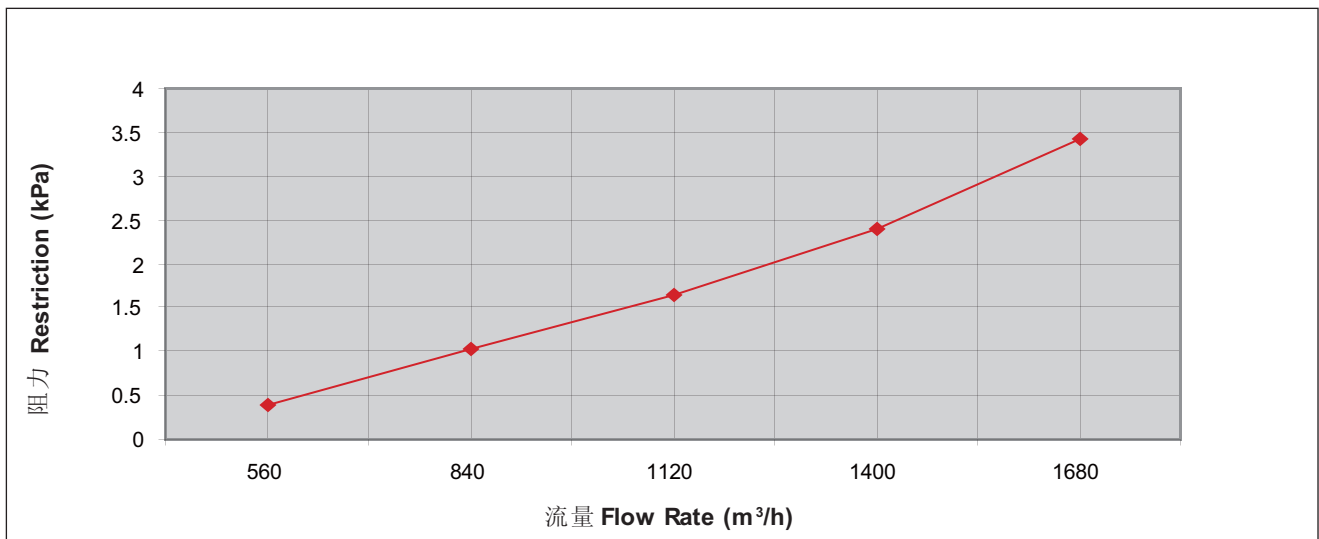

1500 m³/h 流量空滤器(塑料) Air Cleaner (Plastic)

产品型号(订货号) Whole Assembly Sales Part No. : AH8817

| 备件名称 Service Parts Name | 零件号 Part No. | 数量 Qty. | 订货号 Sales Part No. | 滤芯套装订货号 Element SET Sales Part No. | 备注 Notes. |
|-----------------------------|-----------------|------------|-----------------------|---------------------------------------|--------------|
| 主滤芯 Primary Element | A1027-020 | 1 | AF26431 | AA2959 | |
| 安全滤芯 Safety Element | A1027-030 | 1 | AF26432 | | |
| 排灰阀 Dust Ejection Valve | A1027-012B | 1 | | | |
| 防雨帽 Weather Hood | N/A | | | | |
| 抱箍支架 Mounting Bracket | A1027-057 | 2 | | | |
| 阻力指示器 Restriction Indicator | N/A | | | | |
| 堵塞传感器 Jamming Sensor | KLSK01-10 | 1 | KLSK01-10-AM | | 选配 Option |
| 空滤器盖 Cover Assembly | A1027-041 | 1 | | | |
| 旋流片 Fin | A1027-015 | 1 | | | |

产品尺寸图 Dimension:

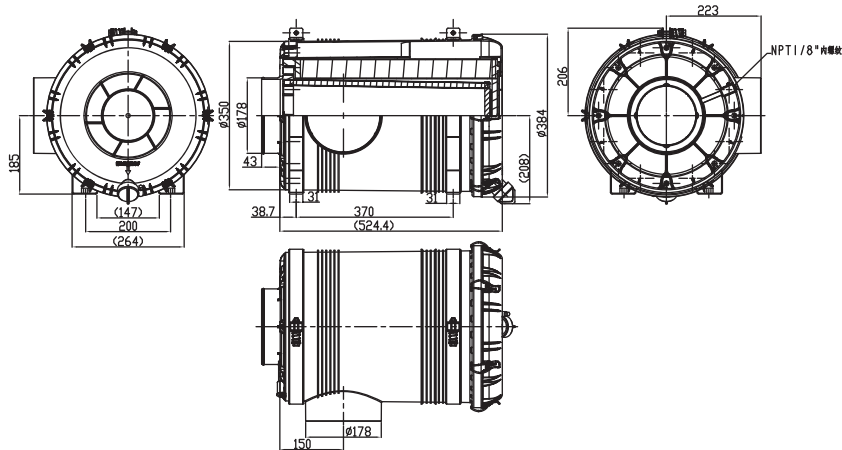

流量阻力曲线图 Restriction-Flow Rate Curve:

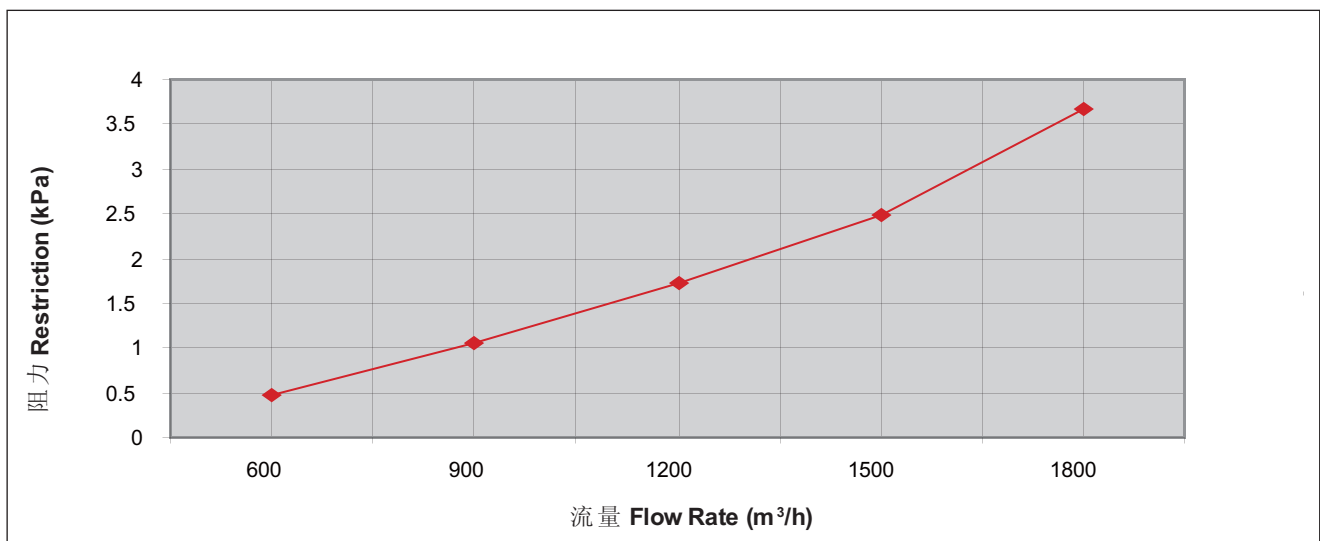

1600 m³/h 流量空滤器 Air Cleaner

产品型号(订货号) Whole Assembly Sales Part No. : A1074

| 备件名称 Service Parts Name | 零件号 Part No. | 数量 Qty. | 订货号 Sales Part No. | 滤芯套装订货号 Element SET Sales Part No. | 备注 Notes. |
|-----------------------------|-----------------|------------|-----------------------|---------------------------------------|--------------|
| 主滤芯 Primary Element | 389515300 | 1 | AF25276 | 1109N12-SET2-AM OR AA2948 | |
| 安全滤芯 Safety Element | 389515600 | 1 | AF25277 | | |
| 排灰阀 Dust Ejection Valve | 389164000 | 1 | | | |
| 防雨帽 Weather Hood | A010-080-B | 1 | 4913719-29 | | |
| 抱箍支架 Mounting Bracket | N/A | | | | |
| 阻力指示器 Restriction Indicator | N/A | | | | |
| 堵塞传感器 Jamming Sensor | KLSK01-10 | 1 | KLSK01-10-AM | | |
| 空滤器盖 Cover Assembly | 389511900 | 1 | 389512100-DBZ | | |
| 旋流片 Fin | 1109N12-015-2 | 1 | | | |

产品尺寸图 Dimension:

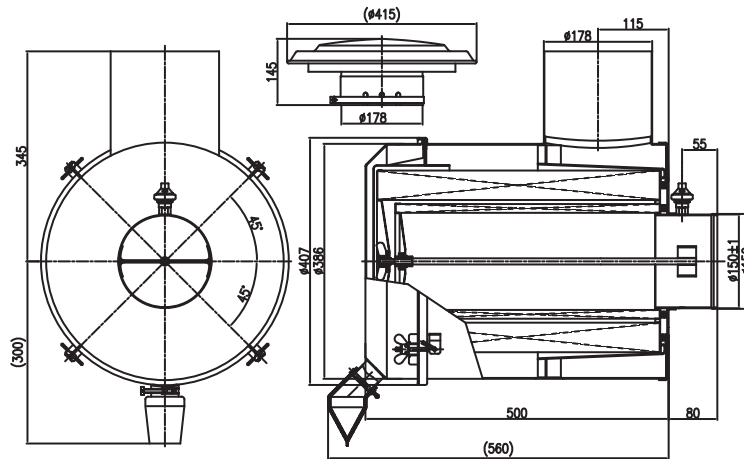

流量阻力曲线图 Restriction-Flow Rate Curve:

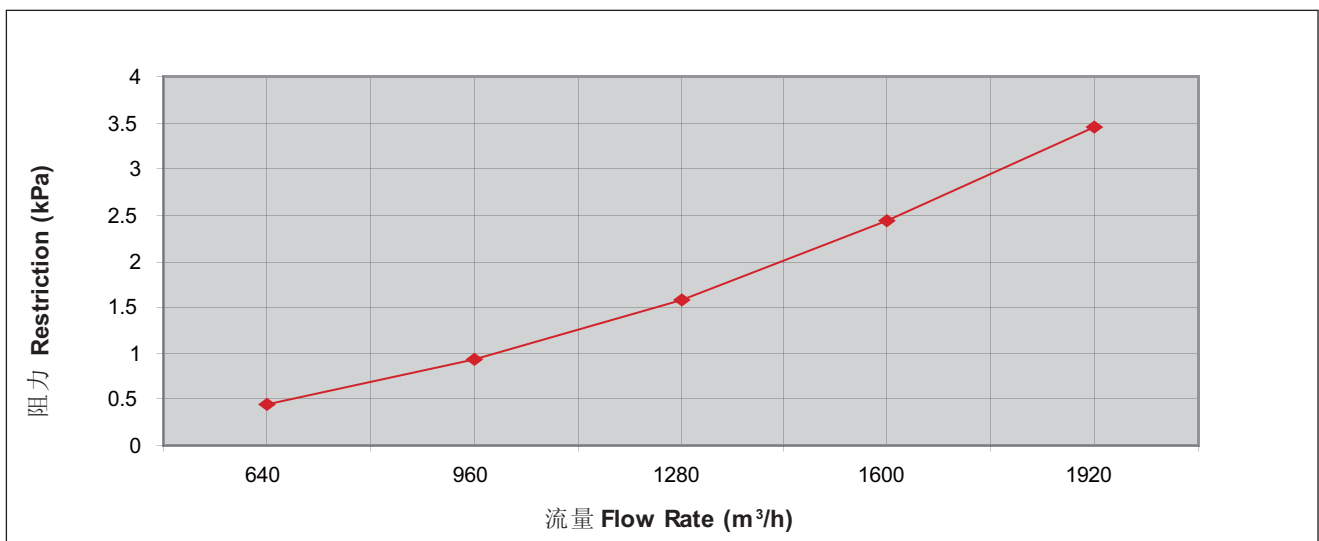

1700 m³/h 流量空滤器 Air Cleaner

产品型号(订货号) Whole Assembly Sales Part No. : A1105

| 备件名称 Service Parts Name | 零件号 Part No. | 数量 Qty. | 订货号 Sales Part No. | 滤芯套装订货号 Element SET Sales Part No. | 备注 Notes. |
|-----------------------------|-----------------|------------|-----------------------|---------------------------------------|--------------|
| 主滤芯 Primary Element | 1109ZB1-020 | 1 | AF25812 | 1109ZB1-SET2-AM OR AA2958 | |
| 安全滤芯 Safety Element | 1109ZB1-030 | 1 | AF25813 | | |
| 排灰阀 Dust Ejection Valve | A011-012 | 1 | | | |
| 防雨帽 Weather Hood | N/A | | | | |
| 抱箍支架 Mounting Bracket | N/A | | | | |
| 阻力指示器 Restriction Indicator | 1W613M | 1 | 1W613M-AM | | |
| 堵塞传感器 Jamming Sensor | N/A | | | | |
| 空滤器盖 Cover Assembly | N/A | 1 | | | |
| 旋流片 Fin | N/A | 1 | | | |

产品尺寸图 Dimension:

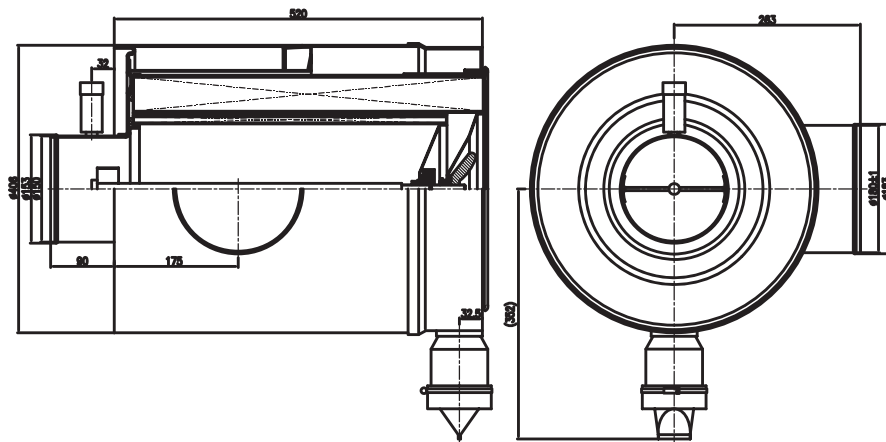

流量阻力曲线图 Restriction-Flow Rate Curve:

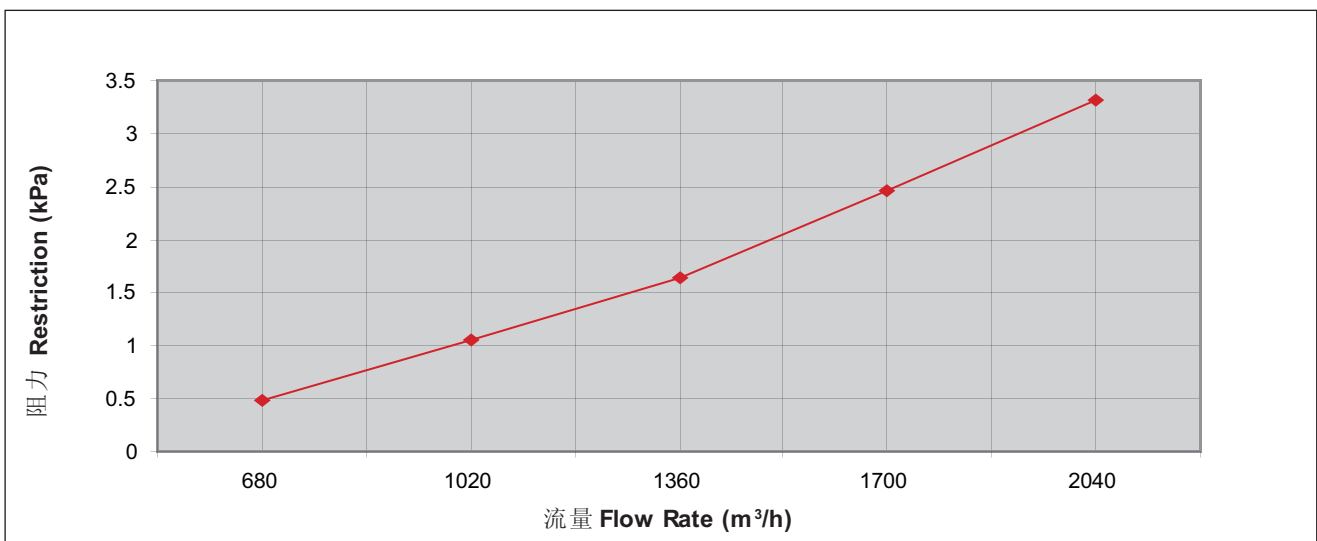

1800 m³/h 流量空滤器 Air Cleaner

产品型号(订货号) Whole Assembly Sales Part No. : AH1911300

| 备件名称 Service Parts Name | 零件号 Part No. | 数量 Qty. | 订货号 Sales Part No. | 滤芯套装订货号 Element SET Sales Part No. | 备注 Notes. |
|-----------------------------|-----------------|------------|-----------------------|---------------------------------------|--------------|
| 主滤芯 Primary Element | 331105200 | 1 | AF891M-A | AF890/AF891M-A | |
| 安全滤芯 Safety Element | 331105000 | 1 | AF890-A | | |
| 排灰阀 Dust Ejection Valve | A011-012 | 1 | | | |
| 防雨帽 Weather Hood | N/A | | | | |
| 抱箍支架 Mounting Bracket | N/A | | | | |
| 阻力指示器 Restriction Indicator | 1W613M | 1 | 1W613M-AM | | 选配 Option |
| 堵塞传感器 Jamming Sensor | KLSK01-10 | 1 | KLSK01-10-AM | | 选配 Option |
| 空滤器盖 Cover Assembly | N/A | 1 | | | |
| 旋流片 Fin | N/A | 1 | | | |

产品尺寸图 Dimension:

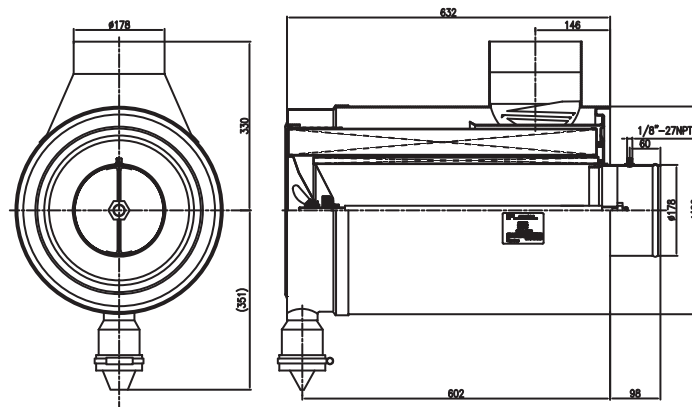

流量阻力曲线图 Restriction-Flow Rate Curve:

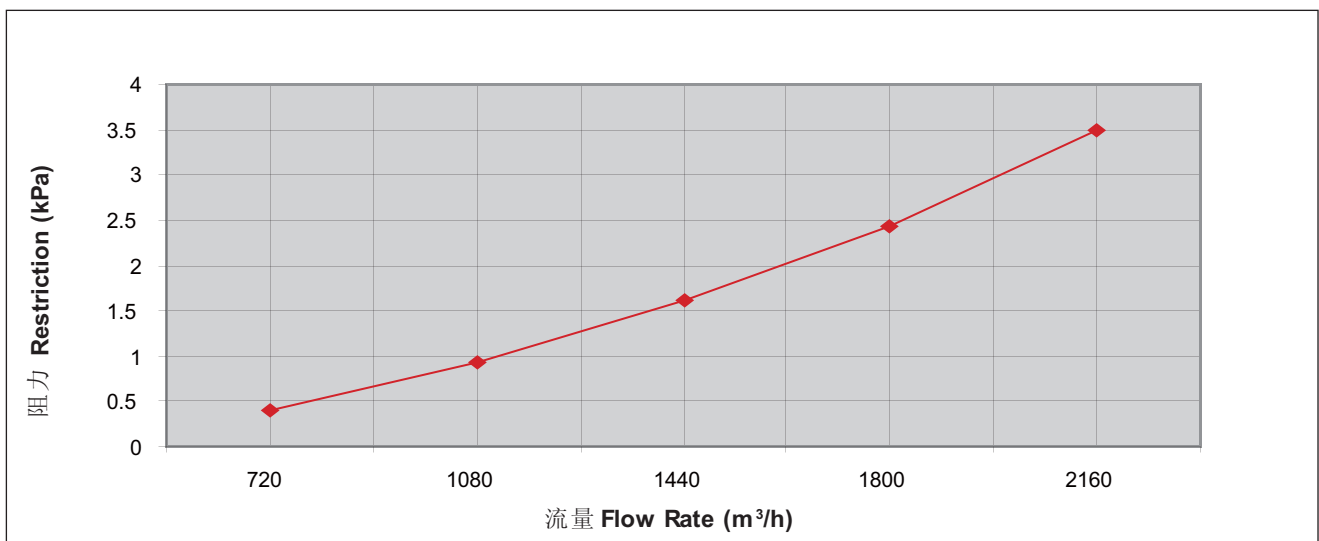

1900 m³/h 流量空滤器 Air Cleaner

产品型号(订货号) Whole Assembly Sales Part No. : AH8822

| 备件名称 Service Parts Name | 零件号 Part No. | 数量 Qty. | 订货号 Sales Part No. | 滤芯套装订货号 Element SET Sales Part No. | 备注 Notes. |
|-----------------------------|-----------------|------------|-----------------------|---------------------------------------|--------------|
| 主滤芯 Primary Element | A1028-020 | 1 | AF26433 | AA2960 | |
| 安全滤芯 Safety Element | A1028-030 | 1 | AF26433 | | |
| 排灰阀 Dust Ejection Valve | A1027-012B | 1 | | | |
| 防雨帽 Weather Hood | N/A | | | | |
| 抱箍支架 Mounting Bracket | A1028-057 | 2 | | | |
| 阻力指示器 Restriction Indicator | N/A | | | | |
| 堵塞传感器 Jamming Sensor | KLSK01-10 | 1 | KLSK01-10-AM | | 选配 Option |
| 空滤器盖 Cover Assembly | A1028-041 | 1 | | | |
| 旋流片 Fin | A1028-015 | 1 | | | |

产品尺寸图 Dimension:

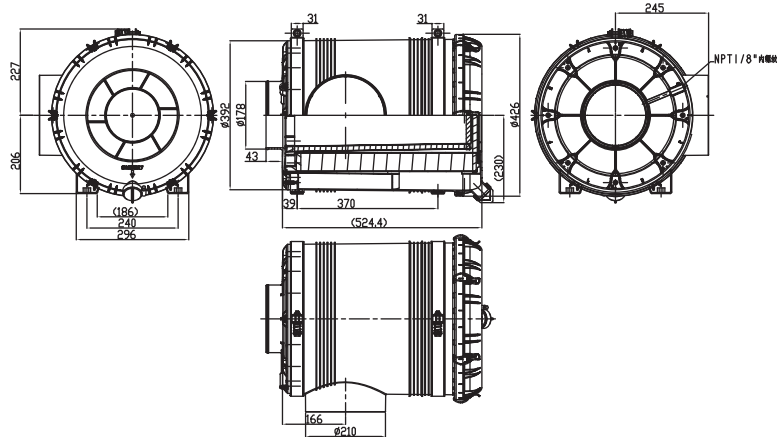

流量阻力曲线图 Restriction-Flow Rate Curve:

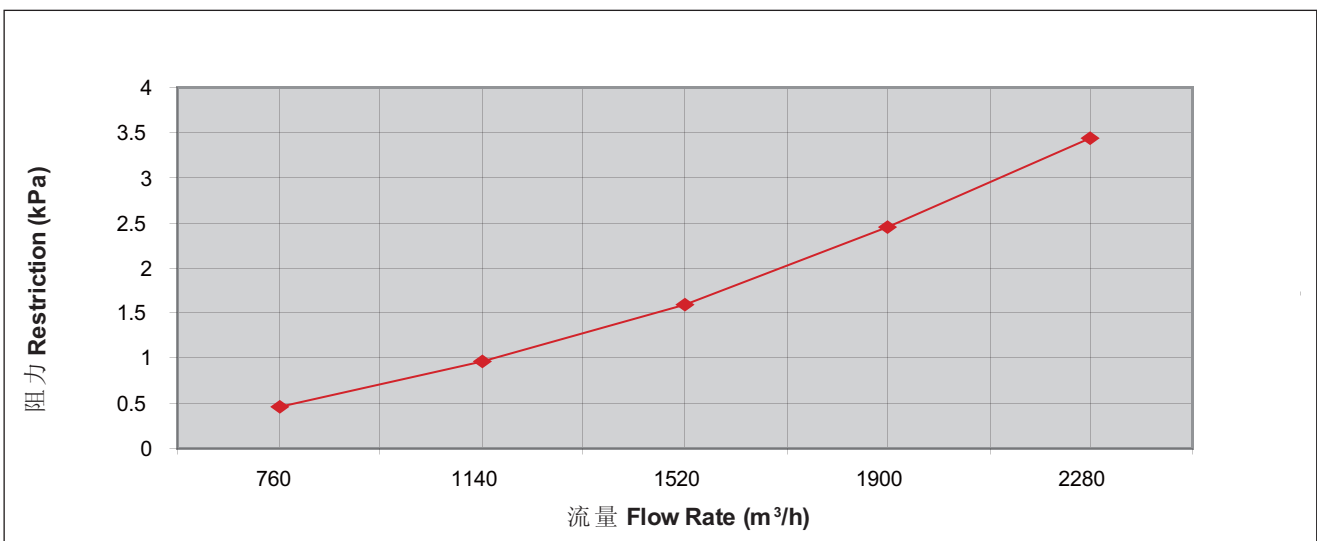

2100 m³/h 流量空滤器 Air Cleaner

产品型号(订货号) Whole Assembly Sales Part No. : A1016

| 备件名称 Service Parts Name | 零件号 Part No. | 数量 Qty. | 订货号 Sales Part No. | 滤芯套装订货号 Element SET Sales Part No. | 备注 Notes. |
|-----------------------------|-----------------|------------|-----------------------|---------------------------------------|--------------|
| 主滤芯 Primary Element | 1109ZB1-020 | 1 | AF25812 | 1109ZB1-SET2-AM OR AA2958 | |
| 安全滤芯 Safety Element | 1109ZB1-030 | 1 | AF25813 | | |
| 排灰阀 Dust Ejection Valve | 389164000 | 1 | | | |
| 防雨帽 Weather Hood | N/A | | | | |
| 抱箍支架 Mounting Bracket | N/A | | | | |
| 阻力指示器 Restriction Indicator | 1W613M | 1 | 1W613M-AM | | |
| 堵塞传感器 Jamming Sensor | N/A | | | | |
| 空滤器盖 Cover Assembly | N/A | 1 | | | |
| 旋流片 Fin | N/A | 1 | | | |

产品尺寸图 Dimension:

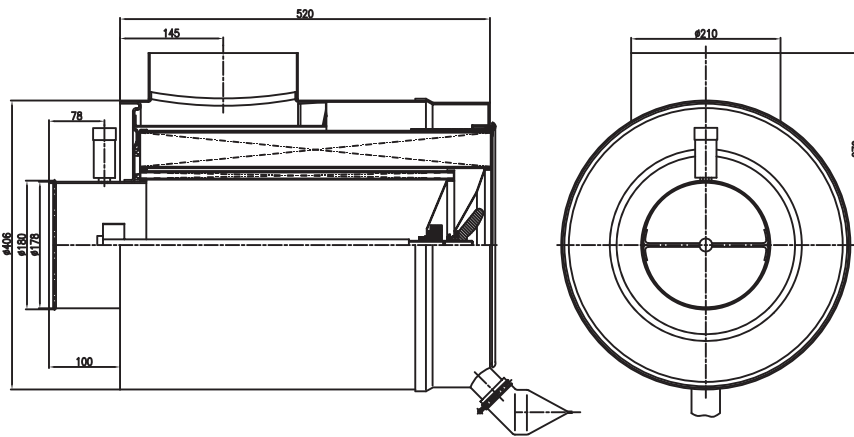

流量阻力曲线图 Restriction-Flow Rate Curve:

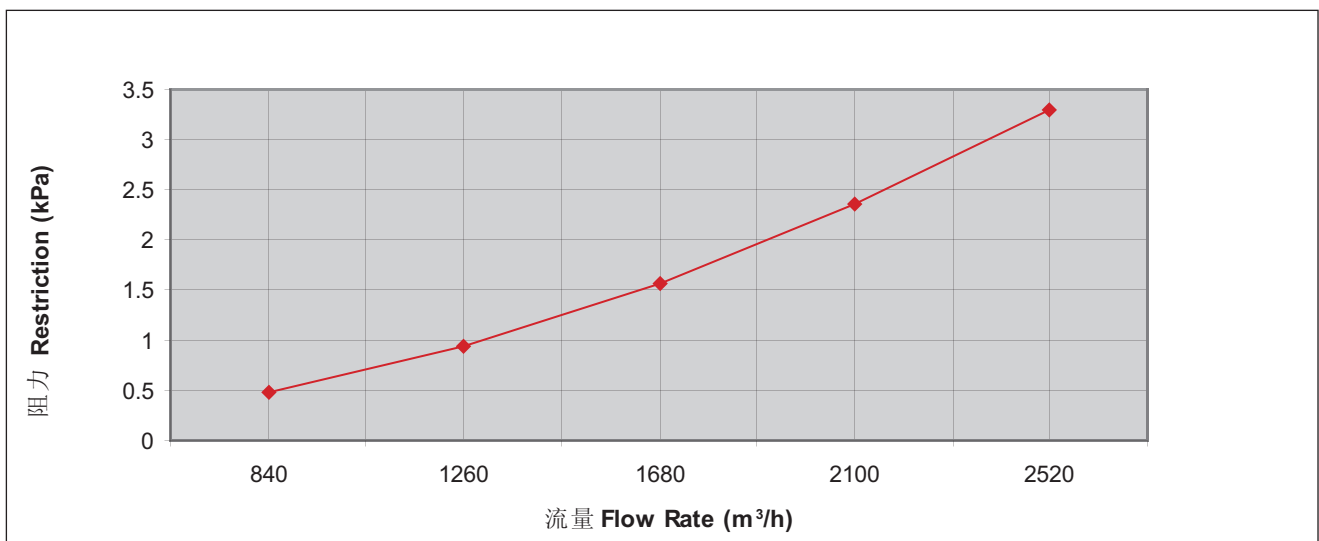

阻力指示器 Restriction Indicator

技术要求:

1. 指示器接头必须垂直安装在直口端。
2. 指示器规定空气滤清器保养指示真空度 6.2 ± 0.5 kPa。
3. 工作温度: $-40^{\circ}\text{C} \sim 100^{\circ}\text{C}$ 。
4. 指示器随着压力的上升, 指示窗口内的颜色应由绿变黄, 直至变成红色。
5. 使用说明书采用中英文双语。

Technical requirements:

1. Indicator of vertical joints must be installed on the straight side .
2. Provides air filters maintenance vacuum instructions. 6.2 ± 0.5 kPa.
3. Operating temperature $-40^{\circ}\text{C} \sim 100^{\circ}\text{C}$.
4. With the increased pressure indicator, instructions window color turn from green to yellow, up to red.
5. Manual for the use of bilingual.

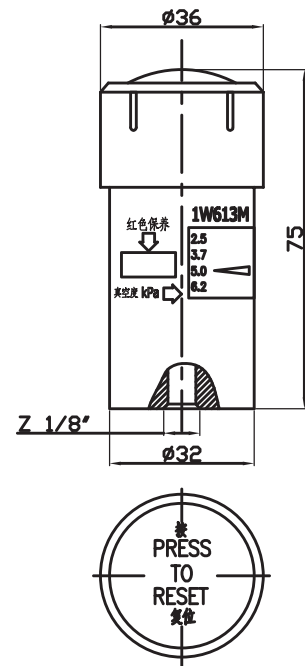

堵塞传感器 Jam Sensor

技术要求:

1. 开关装配应牢固, 不得有松脱现象, 并且保证密封。
2. 开关表称电压 24V, 最大功率 6W, 开关接通的真空度压为 65 ± 6 毫巴。
3. 开关的一接线柱与外壳之间下工作时应绝缘, 耐电压 550V, 50Hz。
4. 工作温度: $-30^{\circ}\text{C} \sim 120^{\circ}\text{C}$ 。

Technical requirements:

1. Switch assembly should be firmly sealed, there shall be no loosening.
2. Switch voltage 24V, Maximum power 6W switch connected to the vacuum pressure 65 ± 6 mbar.
3. Work in the environment, the switch should be with the shell of the terminal insulation resistance, Voltage 550V, 50Hz.
4. Operating temperature $-30 \sim 120^{\circ}\text{C}$.

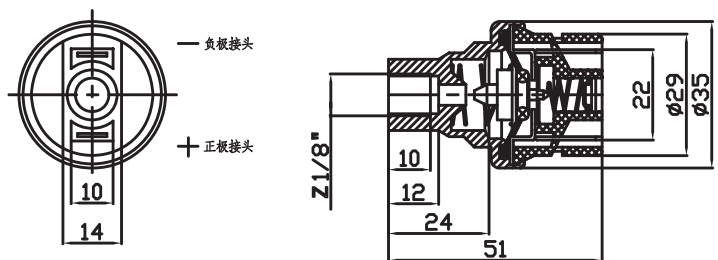

电路图

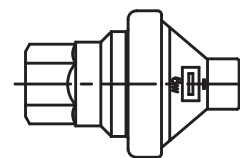
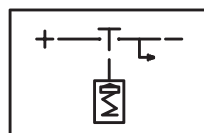

| 产品采购参考 purchase reference | | | | | | | | |
|--|---|---|---|---|---|---|---|-----------------------------|
| SFG系列号 SFG serial No. | F076 | F098 | FS1212 | FS19770 | FS19789 | F043 | F101 | F122 |
| 旋装滤备件号 spin-on filter | FS1242-B-AM | FS19816-B-AM | FS1212-B-M | N/A | FS19789 | F043 | FS19822-B-AM | FS1240-B-AM |
| 旋装滤+透明杯+堵头 spin-on filter+transparent cup+plug | FS1242B-B-AM | FS19816BN /AB-AM | N/A | N/A | N/A | N/A | FS19822B-B-AM | FS1240B-B-AM |
| 旋装滤+透明杯+传感器 spin-on filter+transparent cup+sensor | FS1242BS-B-AM | FS19816BS-B-AM | N/A | N/A | N/A | N/A | FS19822BS-B-AM | FS1240BS-B-AM |
| 旋装滤+透明杯+堵头+底座 spin-on filter+transparent cup+plug+head | F076-B-001 | F098-B-001 | N/A | N/A | N/A | N/A | F101-B-001 | F122-B-001 |
| 旋装滤+透明杯+传感器+底座 spin-on filter+transparent cup+sensor+head | F076-BS-001 | F098-BS-001 | N/A | N/A | N/A | N/A | F101-BS-001 | F122-BS-001 |
| 配件 accessories | | | | | | | | |
| 旋装滤与透明杯之间的密封圈 gasket between spin-on filter and transparent cup | FS19770B-03 | FS19770B-03 | N/A | N/A | N/A | N/A | FS19770B-03 | FS19770B-03 |
| 放水阀密封圈 drain valve gasket | FS19770B-01 | FS19770B-01 | 389202800-A | fs19770OB-01 | 389202800-A | 389202800-A | FS19770B-A01 | FS19770B-01 |
| 传感器/堵头密封圈 sensor / plug gasket | F076-074 | F076-074 | N/A | N/A | N/A | N/A | F076-074 | F076-074 |
| 放水阀带密封圈总成 drain valve with gasket | FS19770B-01 '+'394640500 | FS19770B-01 '+'394640500 | F007-063-A '+' 388922400 | fs19770OB-018-AM | F007-063-A '+' 388922400 | F007-A063-A '+' 388922400 | FS19770B-01 '+'394640500 | FS19770B-01 '+'394640500 |
| 螺纹堵头带密封圈总成 screw plug with gasket | F076-074 '+' F076-077 | F076-074 '+' F076-077 | N/A | N/A | N/A | N/A | F076-074 '+' F076-077 | F076-074 '+' F076-077 |
| 水位传感器密封圈总成备件号 water sensor with gasket No. | F076-073 | F076-073 | N/A | FS19770B-023 | N/A | N/A | F076-073 | F076-073 |
| 底座备件号 head No. | F013-015 | F098-016 | F013-015 | N/A | 1119ZD2A-A011 | F043-015 | F091-A016 | F013-015 |
| 透明杯备件号 transparent cup | F076-071 | F076-A071 | N/A | FS19770B-011 | N/A | N/A | F076-071 | F076-071 |
| 加热器 heat | F076-070 | F098-070 | N/A | N/A | N/A | N/A | N/A | N/A |
| 产品参数参考 product parameter reference | | | | | | | | |
| 额定流量 (L/min) flow rate (L/min) | 5.7 | 5.7 | 5.7 | 5.67 | 2 | 2 | 2 | 1.9 |
| 原始阻力最大 (kPa) original max resistance (kPa) | 5 | 10 | 5 | 5 | 10 | 10 | 5 | 5 |
| 过滤等级 (微米) filter grading (micron) | 25 | 10 | 25 | 10 | 25 | 25 | 10 | 25 |
| 旋装滤直径 (mm) filter diameter | Φ94 | Φ119 | Φ94 | Φ100 | Φ111 | Φ111 | Φ94 | Φ94 |
| 产品总高 (mm) product height | 303 | 350 | 255 | 248 | 310 | 310 | 313 | 225 |
| 产品安装参考 product fixing reference | | | | | | | | |
| 泵后安装 fixed ahead pump | N/A | N/A | N/A | | N/A | N/A | N/A | N/A |
| 泵前安装 fixed back pump | * | * | * | | | * | * | * |
| 接口数量 tie-in number | 2 | 4 | 2 | N/A | 2 | 3 | 3 | 2 |
| 接口A尺寸 tie-in A dimension | M14x1.5 | M14x1.5 | M14x1.5 | 1-14UNS | M18x1.5 | M14x1.5 | M14x1.5 | M14x1.5 |
| 接口B尺寸 tie-in B dimension | N/A | N/A | N/A | N/A | N/A | N/A | N/A | N/A |
| 排水方式 drain method | 手动 | 手动 | 手动 | 手动 | 手动 | 手动 | 手动 | 手动 |
| 产品适用车型 product application | 中卡 middle duty 重卡 heavy duty 客车 bus | 中卡 middle duty 重卡 heavy duty 客车 bus | 中卡 middle duty 重卡 heavy duty 客车 bus | 中卡 middle duty 重卡 heavy duty 客车 bus | 中卡 middle duty 重卡 heavy duty 客车 bus | 中卡 middle duty 重卡 heavy duty 客车 bus | 轻卡 light duty 中卡 middle duty 客车 bus | 轻卡 light duty 客车 bus |
| 欧I排放 Euro I | N/A | N/A | N/A | N/A | N/A | N/A | N/A | N/A |
| 欧II排放 Euro II | * | * | * | * | * | * | * | * |
| 欧三排放 Euro III | N/A | N/A | N/A | N/A | N/A | N/A | N/A | N/A |
| 主机厂参考号 OEM NO. | N/A | N/A | 1119ZB6-010 | N/A | 1119ZD2A-010 | 16400 BT101 | N/A | N/A |

注: 1) 以上表格中“*”代表有此配置, “N/A”代表无此配置。所有红色标注的产品号均为该产品此种配置的订货号。
2) 如需购买产品的配件, 请详细查询上海弗列加客服人员, 免费电话: 800-820-1118

Note: 1) All the “N/A” in the list means “Not Applicable”, all the products number with red mark are also purchase number.
2) More information, Please contact SFG service people. Free toll phone:800-820-1118

| 产品采购参考 purchase reference | | | | | | |
|--|---|---|---|---|---|---|
| SFG系列号 SFG serial No. | F170 | F013 | F186 | F207 | F179 | F212 |
| 旋装滤备件号 spin-on filter | N/A | N/A | F110-020 | FS19922-020 | FS19902 | F043-020 |
| 旋装滤+透明杯+堵头 spin-on filter+transparent cup+plug | N/A | N/A | N/A | N/A | N/A | N/A |
| 旋装滤+透明杯+传感器 spin-on filter+transparent cup+sensor | N/A | N/A | N/A | N/A | N/A | N/A |
| 旋装滤+透明杯+堵头+底座 spin-on filter+transparent cup+plug+head | N/A | N/A | N/A | N/A | N/A | N/A |
| 旋装滤+透明杯+传感器+底座 spin-on filter+transparent cup+sensor+head | N/A | N/A | N/A | N/A | N/A | N/A |
| 配件 accessories | | | | | | |
| 旋装滤与透明杯之间的密封圈 gasket between spin-on filter and transparent cup | N/A | N/A | N/A | N/A | N/A | N/A |
| 放水阀密封圈 drain valve gasket | N/A | N/A | N/A | N/A | N/A | N/A |
| 传感器/堵头密封圈 sensor / plug gasket | N/A | N/A | N/A | N/A | N/A | N/A |
| 放水阀带密封圈总成 drain valve with gasket | N/A | N/A | N/A | N/A | N/A | N/A |
| 螺纹堵头带密封圈总成 screw plug with gasket | N/A | N/A | N/A | N/A | N/A | N/A |
| 水位传感器密封圈总成备件号 water sensor with gasket No. | N/A | N/A | N/A | N/A | N/A | N/A |
| 底座备件号 head No. | N/A | N/A | F098-061C | F098-061C | F109-016 | F098-016B |
| 透明杯备件号 transparent cup | N/A | N/A | F098-070 | F076-070 | N/A | N/A |
| 加热器 heat | N/A | N/A | F186-075 | F186-075 | N/A | N/A |
| 产品参数参考 product parameter reference | | | | | | |
| 额定流量 (L/min) flow rate (L/min) | 8.3 | 5.7 | 5.6 | 5.6 | 4.5 | 4.5 |
| 原始阻力最大 (kPa) original max resistance (kPa) | 4 | 5 | 4 | 4 | 5 | 10 |
| 过滤等级 (微米) filter grading (micron) | NA | 20 | N/A | N/A | N/A | N/A |
| 旋装滤直径 (mm) filter diameter | Φ110 | Φ93 | Φ106 | Φ106 | Φ94 | Φ110 |
| 产品总高 (mm) product height | ~257 | ~255 | ~320 | ~320 | ~260 | ~320 |
| 产品安装参考 product fixing reference | | | | | | |
| 泵后安装 fixed ahead pump | N/A | N/A | N/A | N/A | N/A | N/A |
| 泵前安装 fixed back pump | * | * | * | * | * | * |
| 接口数量 tie-in number | 2 | 2 | 2 | 2 | 2 | 2 |
| 接口A尺寸 tie-in A dimension | M18x1.5 | M14x1.5 | 1-14UNS | 1-14UNS | M24x1.6 | 1-14UNS |
| 接口B尺寸 tie-in B dimension | NA | NA | N/A | N/A | N/A | N/A |
| 排水方式 drain method | 手动 | 手动 | 手动 | 手动 | 手动 | 手动 |
| 产品适用车型 product application | 中卡 middle duty 重卡 heavy duty 客车 bus | 中卡 middle duty 重卡 heavy duty 客车 bus | 中卡 middle duty 重卡 heavy duty 客车 bus | 中卡 middle duty 重卡 heavy duty 客车 bus | 中卡 middle duty 重卡 heavy duty 客车 bus | 中卡 middle duty 重卡 heavy duty 客车 bus |
| 欧I排放 Euro I | * | * | * | * | * | * |
| 欧II排放 Euro II | * | * | * | * | * | * |
| 欧三排放 Euro III | * | * | * | * | * | * |
| 主机厂参考号 OEM NO. | 1105030-T0102 | 16400DT000 | N/A | N/A | N/A | N/A |

注: 1) 以上表格中“*”代表有此配置, “N/A”代表无此配置。所有红色标注的产品号均为该产品此种配置的订货号。
2) 如需购买产品的配件, 请详细查询上海弗列加客服人员, 免费电话: 800-820-1118

Note: 1) All the “N/A” in the list means “Not Applicable”, all the products number with red mark are also purchase number.
2) More information, Please contact SFG service people. Free toll phone: 800-820-1118

| 产品采购参考 purchase reference | | | | | | |
|--|---|---|---|---|---|---|
| SFG系列号 SFG serial No. | F047 | 1119N-020 | F081 | F082 | FS19523 | F084 |
| 旋装滤备件号 spin-on filter | N/A | FF5327-AM | N/A | N/A | N/A | N/A |
| 旋装滤+透明杯+堵头 spin-on filter+transparent cup+plug | N/A | N/A | N/A | N/A | N/A | N/A |
| 旋装滤+透明杯+传感器 spin-on filter+transparent cup+sensor | N/A | N/A | N/A | N/A | N/A | N/A |
| 旋装滤+透明杯+堵头+底座 spin-on filter+transparent cup+plug+head | N/A | N/A | N/A | N/A | N/A | N/A |
| 旋装滤+透明杯+传感器+底座 spin-on filter+transparent cup+sensor+head | N/A | N/A | N/A | N/A | N/A | N/A |
| 配件 accessories | | | | | | |
| 旋装滤与透明杯之间的密封圈 gasket between spin-on filter and transparent cup | N/A | N/A | N/A | N/A | N/A | N/A |
| 放水阀密封圈 drain valve gasket | N/A | 389202800-A | N/A | N/A | N/A | N/A |
| 传感器/堵头密封圈 sensor / plug gasket | N/A | N/A | N/A | N/A | N/A | N/A |
| 放水阀带密封圈总成 drain valve with gasket | N/A | F007-063-A '+' 388922400 | N/A | N/A | N/A | N/A |
| 螺纹堵头带密封圈总成 screw plug with gasket | N/A | N/A | N/A | N/A | N/A | N/A |
| 水位传感器密封圈总成备件号 water sensor with gasket No. | N/A | N/A水位 | N/A | N/A | N/A | N/A |
| 底座备件号 head No. | N/A | 1119N-21 | N/A | N/A | N/A | N/A |
| 透明杯备件号 transparent cup | N/A | N/A | N/A | N/A | N/A | N/A |
| 加热器 heat | N/A | N/A | N/A | N/A | N/A | N/A |
| 产品参数参考 product parameter reference | | | | | | |
| 额定流量 (L/min) flow rate (L/min) | 3 | 2 | 1.2 | 1.2 | 1.2 | 1.2 |
| 原始阻力最大 (kPa) original max resistance (kPa) | 5.3 | 2 | 5 | 5 | 5 | 5 |
| 过滤等级 (微米) filter grading (micron) | N/A | N/A | N/A | N/A | N/A | N/A |
| 旋装滤直径 (mm) filter diameter | Φ95 | Φ78 | Φ70 | Φ70 | Φ70 | Φ70 |
| 产品总高 (mm) product height | ~250 | 202 | ~250 | ~250 | ~250 | ~250 |
| 产品安装参考 product fixing reference | | | | | | |
| 泵后安装 fixed ahead pump | N/A | N/A | N/A | N/A | N/A | N/A |
| 泵前安装 fixed back pump | * | * | * | * | * | * |
| 接口数量 tie-in number | 2 | 2 | 2 | 2 | 2 | 2 |
| 接口A尺寸 tie-in A dimension | NA | M14x1.5 | N/A | N/A | N/A | N/A |
| 接口B尺寸 tie-in B dimension | NA | N/A | Φ8 | Φ8 | Φ8 | Φ8 |
| 排水方式 drain method | 手动 | 手动 | 手动 | 手动 | 手动 | 手动 |
| 产品适用车型 product application | 轻卡 light duty 中卡 middle duty 客车 bus | 轻卡 light duty 中卡 middle duty 客车 bus | 轻卡 light duty 中卡 middle duty 客车 bus | 轻卡 light duty 中卡 middle duty 客车 bus | 轻卡 light duty 中卡 middle duty 客车 bus | 轻卡 light duty 皮卡 Pick-up truck 客车 bus |
| 欧I排放 Euro I | * | * | * | * | * | * |
| 欧II排放 Euro II | * | * | * | * | * | * |
| 欧三排放 Euro III | * | N/A | N/A | N/A | N/A | * |
| 主机厂参考号 OEM NO. | 897240-1261 | 1119N-019/020 | 1119J37-001 | 1119J33B-001 | 1119QE-010 | 1119QF18-001 |

注: 1) 以上表格中“*”代表有此配置, “N/A”代表无此配置。所有红色标注的产品号均为该产品此种配置的订货号。
2) 如需购买产品的配件, 请详细查询上海弗列加客服人员, 免费电话: 800-820-1118

Note: 1) All the “N/A” in the list means “Not Applicable”, all the products number with red mark are also purchase number.
2) More information, Please contact SFG service people. Free toll phone: 800-820-1118

| 产品采购参考 purchase reference | | | | | | | | | | |
|--|---|---|---|---|---|---|---|---|---|---|
| SFG系列号 SFG serial No. | FS1006-001 | FS19898 | FS1242 | FS1000-001 | FS1003-B | FS1212-B-AM | FS1251-import | FS1282-B | FS1280-B-AM | FS19822 |
| 旋装滤备件号 spin-on filter | N/A | N/A | FS1242-B-AM | N/A | N/A | N/A | N/A | N/A | N/A | FS19822-B-AM |
| 旋装滤+透明杯+堵头 spin-on filter+transparent cup+plug | N/A | N/A | FS1242B-B-AM | N/A | N/A | N/A | N/A | N/A | N/A | FS19822B-B-AM |
| 旋装滤+透明杯+传感器 spin-on filter+transparent cup+sensor | N/A | N/A | FS1242BS-B-AM | N/A | N/A | N/A | N/A | N/A | N/A | FS19822BS-B-AM |
| 旋装滤+透明杯+堵头+底座 spin-on filter+transparent cup+plug+head | N/A | N/A | N/A | N/A | N/A | N/A | N/A | N/A | N/A | N/A |
| 旋装滤+透明杯+传感器+底座 spin-on filter+transparent cup+sensor+head | N/A | N/A | N/A | N/A | N/A | N/A | N/A | N/A | N/A | N/A |
| 配件 accessories | | | | | | | | | | |
| 旋装滤与透明杯之间的密封圈 gasket between spin-on filter and transparent cup | N/A | N/A | FS19770B-03 | N/A | N/A | N/A | N/A | N/A | N/A | FS19770B-03 |
| 放水阀密封圈 drain valve gasket | LF3325-021 | f007-063-A | FS19770B-01 | 389079800-A | 389079800-A | 389202800-A | N/A | 389202800-A | 389202800-A | FS19770B-01 |
| 传感器/堵头密封圈 sensor / plug gasket | NA | 394094200 | F076-074 | N/A | 391194000 | N/A | N/A | N/A | N/A | F076-074 |
| 放水阀带密封圈总成 drain valve with gasket | 388922400 | f007-063-A | FS19770B-01 '+'394640500 | 388922400 | 388922400 | F007-A063-A '+' 388922400 | 388922400 | F007-063-A '+' 388922400 | F007-A063-A '+' 388922400 | FS19770B-01 '+'394640500 |
| 螺纹堵头带密封圈总成 screw plug with gasket | N/A | N/A | F076-074 '+' F076-077 | N/A | N/A | N/A | N/A | N/A | N/A | F076-074 '+' F076-077 |
| 水位传感器密封圈总成备件号 water sensor with gasket No. | N/A | N/A | F076-073 | N/A | N/A | N/A | N/A | N/A | N/A | F076-073 |
| 底座备件号 head No. | N/A | N/A | N/A | N/A | N/A | N/A | N/A | N/A | N/A | N/A |
| 透明杯备件号 transparent cup | N/A | N/A | F076-071 | N/A | N/A | N/A | N/A | N/A | N/A | F076-071 |
| 加热器 heat | N/A | N/A | N/A | N/A | N/A | N/A | N/A | N/A | N/A | N/A |
| 产品参数参考 product parameter reference | | | | | | | | | | |
| 额定流量 (L/min) flow rate (L/min) | 11.3 | 7.5 | 5.7 | 5.67 | 5.67 | 5.67 | 3.8 | 3.8 | 3.8 | 2 |
| 原始阻力最大 (kPa) original max resistance (kPa) | 5 | 5 | 2 | 5 | 5 | 2 | 5 | 2 | 2 | 2 |
| 过滤等级 (微米) filter grading (micron) | 10 | 10 | 25 | 10 | 10 | 25 | 10 | 25 | 25 | 10 |
| 旋装滤直径 (mm) filter diameter | Φ116 | Φ107 | Φ94 | Φ93.5 | Φ94.3 | Φ94 | Φ77.8 | Φ94 | Φ94 | Φ94 |
| 产品总高 (mm) product height | 314 | 262 | 168 | 249 | 249 | 201 | 139 | 163 | 163 | 168 |
| 产品安装参考 product fixing reference | | | | | | | | | | |
| 泵后安装 fixed ahead pump | N/A | | N/A | N/A | N/A | N/A | N/A | N/A | * | N/A |
| 泵前安装 fixed back pump | * | | * | * | * | * | * | * | N/A | * |
| 接口数量 tie-in number | N/A | N/A | N/A | N/A | N/A | N/A | N/A | N/A | N/A | N/A |
| 接口A尺寸 tie-in A dimension | 1 1/4-12 UNS | 1-14UNS | 1-14UNS | 1-14UNS | 1-14UNS | 1-14UNS | M16X1.5 | 1-14UNS | 13/16-18UNS | 1-14UNS |
| 接口B尺寸 tie-in B dimension | N/A | N/A | N/A | N/A | N/A | N/A | N/A | N/A | N/A | N/A |
| 排水方式 drain method | 手动 | 手动 | 手动 | 手动 | 手动 | 手动 | 手动 | 手动 | 手动 | 手动 |
| 产品适用车型 product application | 中卡 middle duty 重卡 heavy duty 客车 bus | 中卡 middle duty 重卡 heavy duty 客车 bus | 中卡 middle duty 重卡 heavy duty 客车 bus | 中卡 middle duty 重卡 heavy duty 客车 bus | 中卡 middle duty 重卡 heavy duty 客车 bus | 中卡 middle duty 重卡 heavy duty 客车 bus | 中卡 middle duty 重卡 heavy duty 客车 bus | 中卡 middle duty 重卡 heavy duty 客车 bus | 中卡 middle duty 重卡 heavy duty 客车 bus | 轻卡 light duty 中卡 middle duty 客车 bus |
| 欧I排放 Euro I | N/A | N/A | N/A | N/A | N/A | N/A | N/A | N/A | N/A | N/A |
| 欧II排放 Euro II | * | * | * | * | * | * | * | * | * | N/A |
| 欧三排放 Euro III | N/A | N/A | N/A | N/A | N/A | N/A | N/A | N/A | N/A | N/A |
| 主机厂参考号 OEM NO. | N/A | N/A | N/A | N/A | N/A | 3315843 | N/A | 3843447 | 3930942 | 1125N-A010 |

注: 1) 以上表格中“*”代表有此配置, “N/A”代表无此配置。所有红色标注的产品号均为该产品此种配置的订货号。
2) 如需购买产品的配件, 请详细查询上海弗列加客服人员, 免费电话: 800-820-1118

Note: 1) All the “N/A” in the list means “Not Applicable”, all the products number with red mark are also purchase number.
2) More information, Please contact SFG service people. Free toll phone:800-820-1118

| 产品采购参考 purchase reference | | | | |
|--|-----------------------------|-----------------------------|-----------------------------|-----------------------------|
| SFG系列号 SFG serial No. | FS19686 | FS1240-B-AM | FS19607 | FS19587-B-AM |
| 旋装滤备件号 spin-on filter | N/A | FS1240-B-AM | N/A | N/A |
| 旋装滤+透明杯+堵头 spin-on filter+transparent cup+plug | N/A | FS1240B-B-AM | N/A | N/A |
| 旋装滤+透明杯+传感器 spin-on filter+transparent cup+sensor | N/A | FS1240BS-B-AM | N/A | N/A |
| 旋装滤+透明杯+堵头+底座 spin-on filter+transparent cup+plug+head | N/A | N/A | N/A | N/A |
| 旋装滤+透明杯+传感器+底座 spin-on filter+transparent cup+sensor+head | N/A | N/A | N/A | N/A |
| 配件 accessories | | | | |
| 旋装滤与透明杯之间的密封圈 gasket between spin-on filter and transparent cup | N/A | FS19770B-03 | N/A | N/A |
| 放水阀密封圈 drain valve gasket | 389202800-A | FS19770B-01 | 389202800-A | 389202800-A |
| 传感器/堵头密封圈 sensor / plug gasket | N/A | F076-074 | N/A | N/A |
| 放水阀带密封圈总成 drain valve with gasket | F007-063-A '+' 388922400 | FS19770B-01 '+'394640500 | F007-063-A '+' 388922400 | F007-063-A '+' 388922400 |
| 螺纹堵头带密封圈总成 screw plug with gasket | N/A | F076-074 '+' F076-077 | N/A | N/A |
| 水位传感器密封圈总成备件号 water sensor with gasket No. | N/A | F076-073 | N/A | N/A |
| 底座备件号 head No. | N/A | N/A | N/A | N/A |
| 透明杯备件号 transparent cup | N/A | F076-071 | N/A | N/A |
| 加热器 heat | N/A | N/A | N/A | N/A |
| 产品参数参考 product parameter reference | | | | |
| 额定流量 (L/min) flow rate (L/min) | 2 | 1.9 | 1.2 | 0.8 |
| 原始阻力最大(kPa)original max resistance (kPa) | 2 | 2 | 2 | 2 |
| 过滤等级(微米) filter grading (micron) | 25 | 25 | 25 | 25 |
| 旋装滤直径(mm) filter diameter | Φ111 | Φ94 | Φ82 | Φ78 |
| 产品总高(mm) product height | 187 | 92 | 184 | 150 |
| 产品安装参考 product fixing reference | | | | |
| 泵后安装 fixed ahead pump | N/A | N/A | N/A | N/A |
| 泵前安装 fixed back pump | * | * | * | * |
| 接口数量 tie-in number | N/A | N/A | N/A | N/A |
| 接口A尺寸 tie-in A dimension | 1-14UNS | 1-14UNS | M16x1.5 | M20x1.5 |
| 接口B尺寸 tie-in B dimension | N/A | N/A | N/A | N/A |
| 排水方式 drain method | 手动 | 手动 | 手动 | 手动 |
| 产品适用车型 product application | | | | |
| 轻卡 light duty 中卡 middle duty 客车 bus | | 轻卡 light duty 客车 bus | 轻卡 light duty 客车 bus | 轻卡 light duty 客车 bus |
| 欧I排放 Euro I | N/A | N/A | N/A | N/A |
| 欧II排放 Euro II | * | * | * | * |
| 欧三排放 Euro III | N/A | N/A | N/A | N/A |
| 主机厂参考号 OEM NO. | 150-1105020A | N/A | 1117040-D6 | 4102.15.00A |

注：1) 以上表格中“*”代表有此配置，“N/A”代表无此配置。所有红色标注的产品号均为该产品此种配置的订货号。

2) 如需购买产品的配件，请详细查询上海弗列加客服人员，免费电话：800-820-1118

Note: 1) All the “N/A” in the list means “Not Applicable”, all the products number with red mark are also purchase number.

2) More information, Please contact SFG service people. Free toll phone:800-820-1118

F207组成示意图
F207 sketch map



1.带放水阀有水分离器
F/W Filter with drain valve



2.带底座预滤器
Pre-Cleaner with head



3.旋装式油水分离器
Spin-on F/W Filter



请到上海弗列加指定授权的经销商处购买

Please purchase our products in the
Shanghai Fleetguard authorized franchised



www.shanghaifleetguard.com

上海弗列加滤清器有限公司
SHANGHAI FLEETGUARD FILTER CO.,LTD.
地址: 上海浦东杨高北路3595号 邮编(ZIP): 201208
Add: 3595# North Yang Gao Road. Pudong, Shanghai
电话(Tel) / 传真(Fax): 021-58657950 / 58658066